



FIXTURE INSTALLATION INSTRUCTIONS

ver. 2022



Introduction:

Carefully read and follow the contents of these instructions in sequence for the correct step-by-step procedure to assemble the fixture.

In the event of assembly problems or missing hardware, please contact Customer Service for assistance at 800-662-8640 x0, Monday - Friday, 8:30am - 5:00pm CST.

CAUTION!

Assembled fixture is very heavy. Do not attempt to lift or move without assistance.

Tools Required:

- Power Drill
- #2 Square Drive Bit
- Tape Measure
- Phillips Head Screwdriver
- 3/16" Concrete Drill Bit (included)
- Bubble Level
- 1/4" Nut Driver

TABLE OF CONTENTS

Section 1: Installation Preparation & Hardware	2
Section 2: Install Structure	5
Section 3: Install Top Sign	13
Illuminated Panel Kit (Optional Add-On)	16
Section 4: Storage Cabinet Option or Shelf Installation	18
Section 5: Install Storage Cabinets (Optional Add-On)	19
Section 6: Install Shelves	24
Section 7: Install Pushers	26



THE MANUFACTURER OF THIS MERCHANDISING SYSTEM ASSUMES NO LIABILITY FOR INJURY, DAMAGE OR LOSS OF PROPERTY AS A RESULT OF IMPROPER ASSEMBLY, INSTALLATION, AND/OR USE OF THIS DISPLAY.

Installation Preparation - 1.1

STEP 1: Unpack And Identify AIM Standard Fixture Components

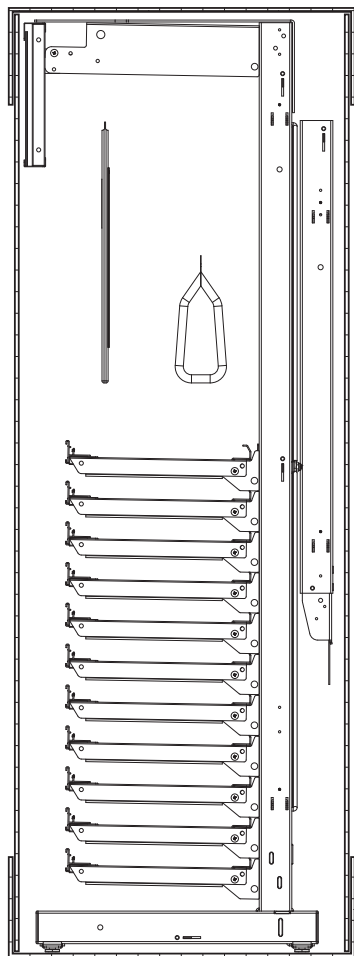

EACH AIM STANDARD FIXTURE,
2FT, 3FT, 4FT, IS PACKED
IN A SINGLE CARTON

THE MANUFACTURER OF THIS MERCHANDISING SYSTEM ASSUMES NO LIABILITY FOR INJURY, DAMAGE OR LOSS OF PROPERTY AS A RESULT OF IMPROPER ASSEMBLY, INSTALLATION, AND/OR USE OF THIS DISPLAY.

(1) TOP SIGN
COVER



(1) TOP SIGN KIT

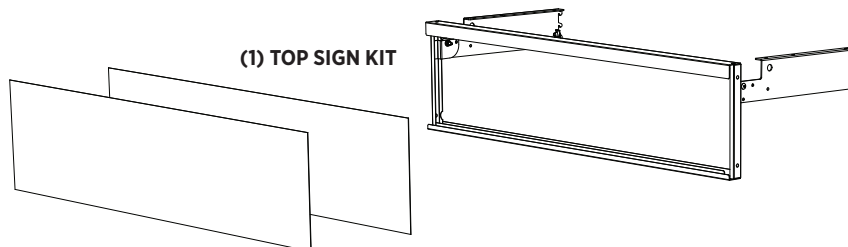

(1) STANDARD
EXTENSION

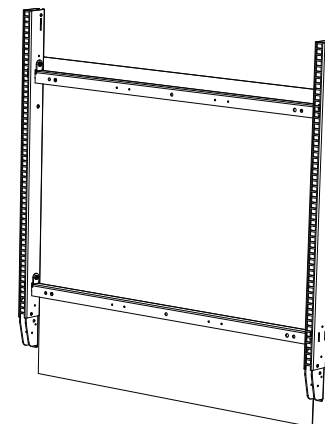

(1) BAG CONTAINING INSTRUCTION SHEET
BOOKLET AND COUNTING STICK

(1) HARDWARE BAG
CONTENTS LIST ON NEXT PAGE

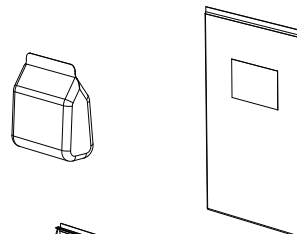

(11) SHELF

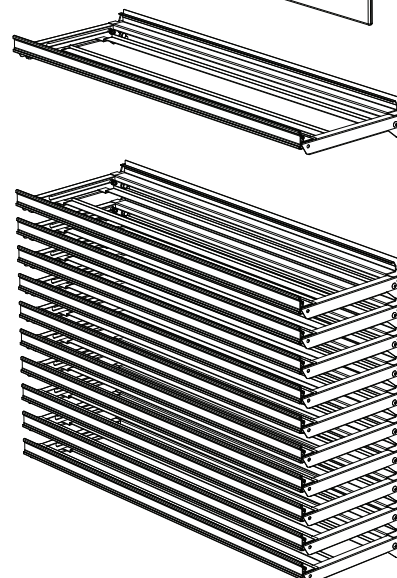

(1) LOW PROFILE
BASE STRUCTURE

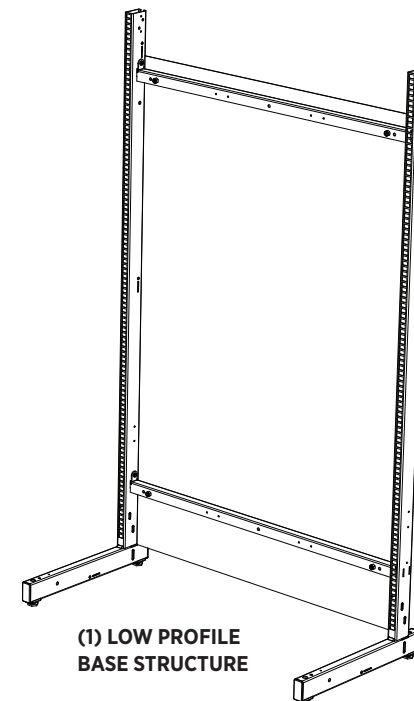

Installation Preparation - 1.2

Hardware Bag Contents and Counting Stick - Included With Each AIM Standard Fixture

Wall Attaching Hardware

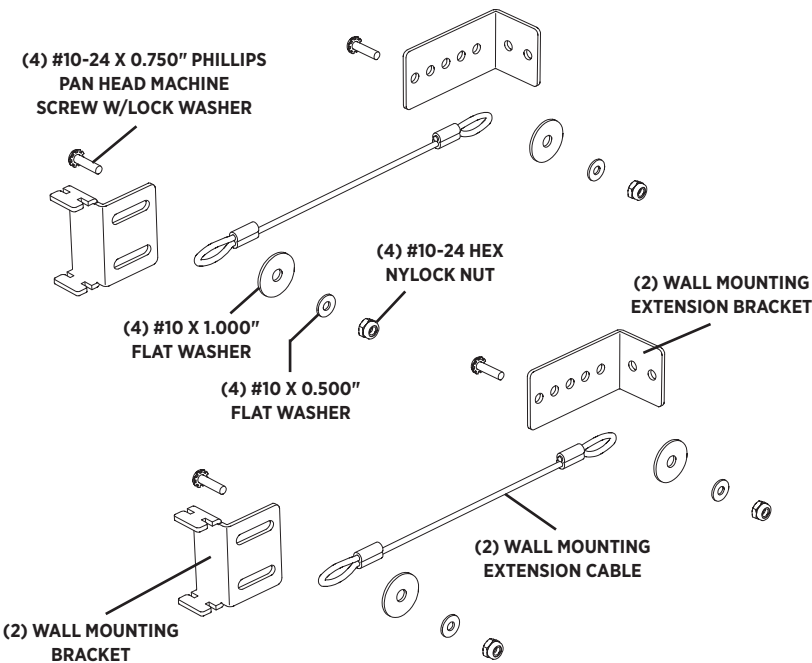

Leg Attaching Hardware

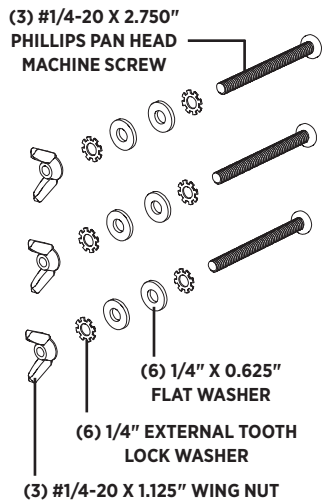

Top Sign Kit Hardware

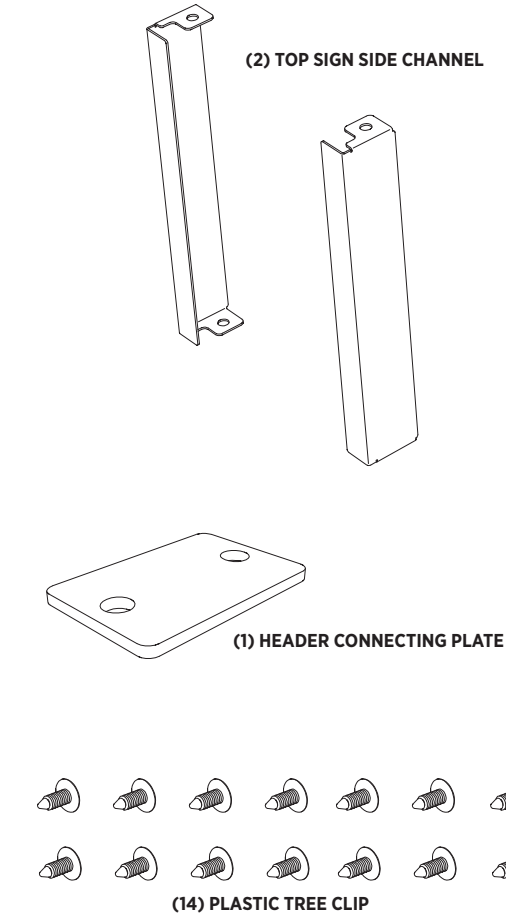

Floor Attaching Hardware

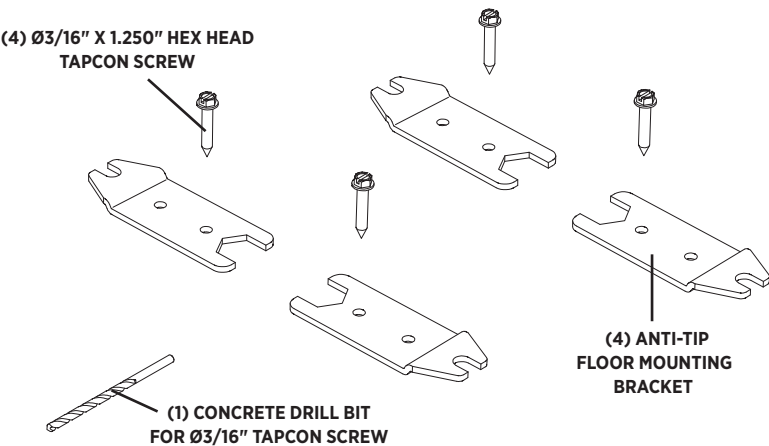

Standard Extension Connecting Hardware

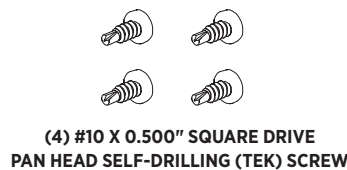

Counting Stick For Cigarette Package Inventory



Shelf Installation Accessories

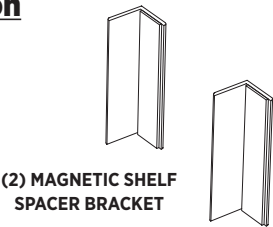

Installation Preparation - 1.3

STEP 2: Remove Top Sign And Shelves From Base Structure

- Remove Top Sign Cover and set aside (it is not attached).
- Pivot rotating locks on both Top Sign side brackets, away from the slots in uprights, to unlock. (DETAIL 2A and 2B)
- Grip side brackets of Top Sign, lift directly upward to release from slots, then tilt entire Top Sign assembly toward the back of the structure to remove it from uprights. (DETAIL 2C)
- Set Top Sign structure aside until instructed to reinstall.
- Unlock both rotating locks at the back of each shelf, and remove all shelves from Low Profile Base Structure in the same manner. (DETAIL 2C)
- Set shelves aside until instructed to reinstall.

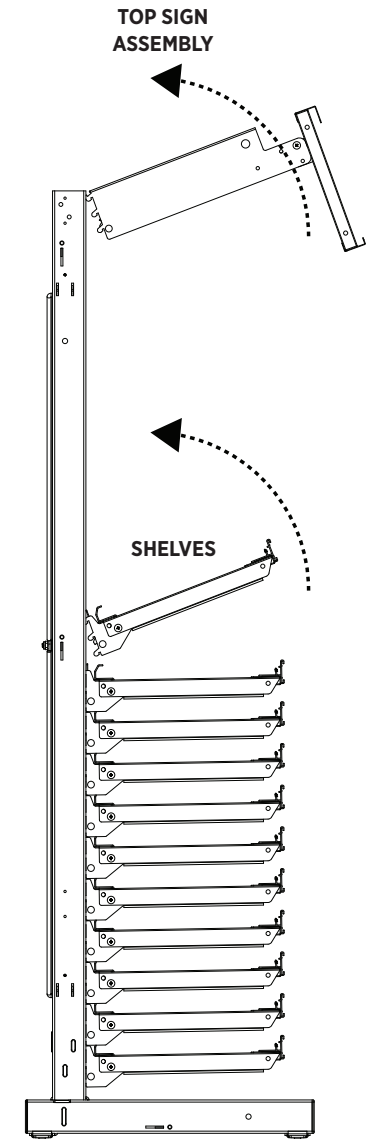
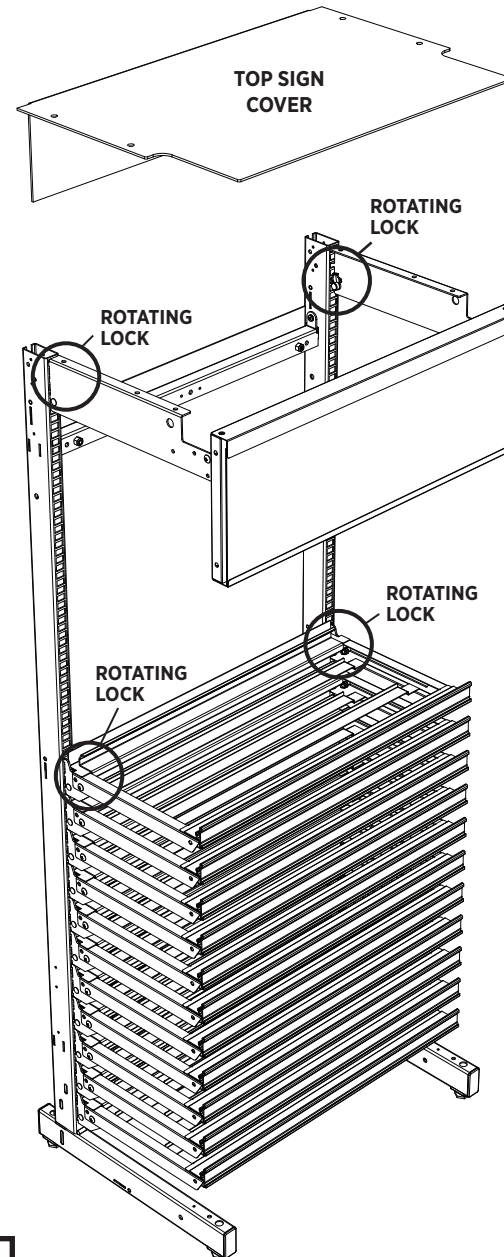
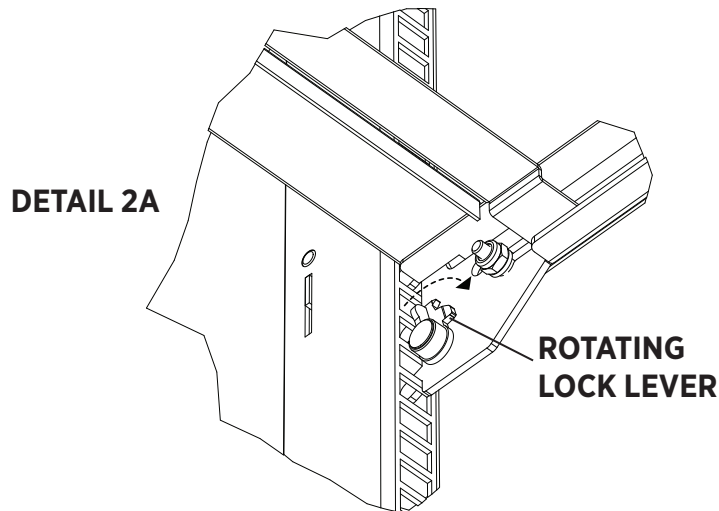

THE MANUFACTURER OF THIS MERCHANDISING SYSTEM ASSUMES NO LIABILITY FOR INJURY, DAMAGE OR LOSS OF PROPERTY AS A RESULT OF IMPROPER ASSEMBLY, INSTALLATION, AND/OR USE OF THIS DISPLAY.

Install Structure - 2.1

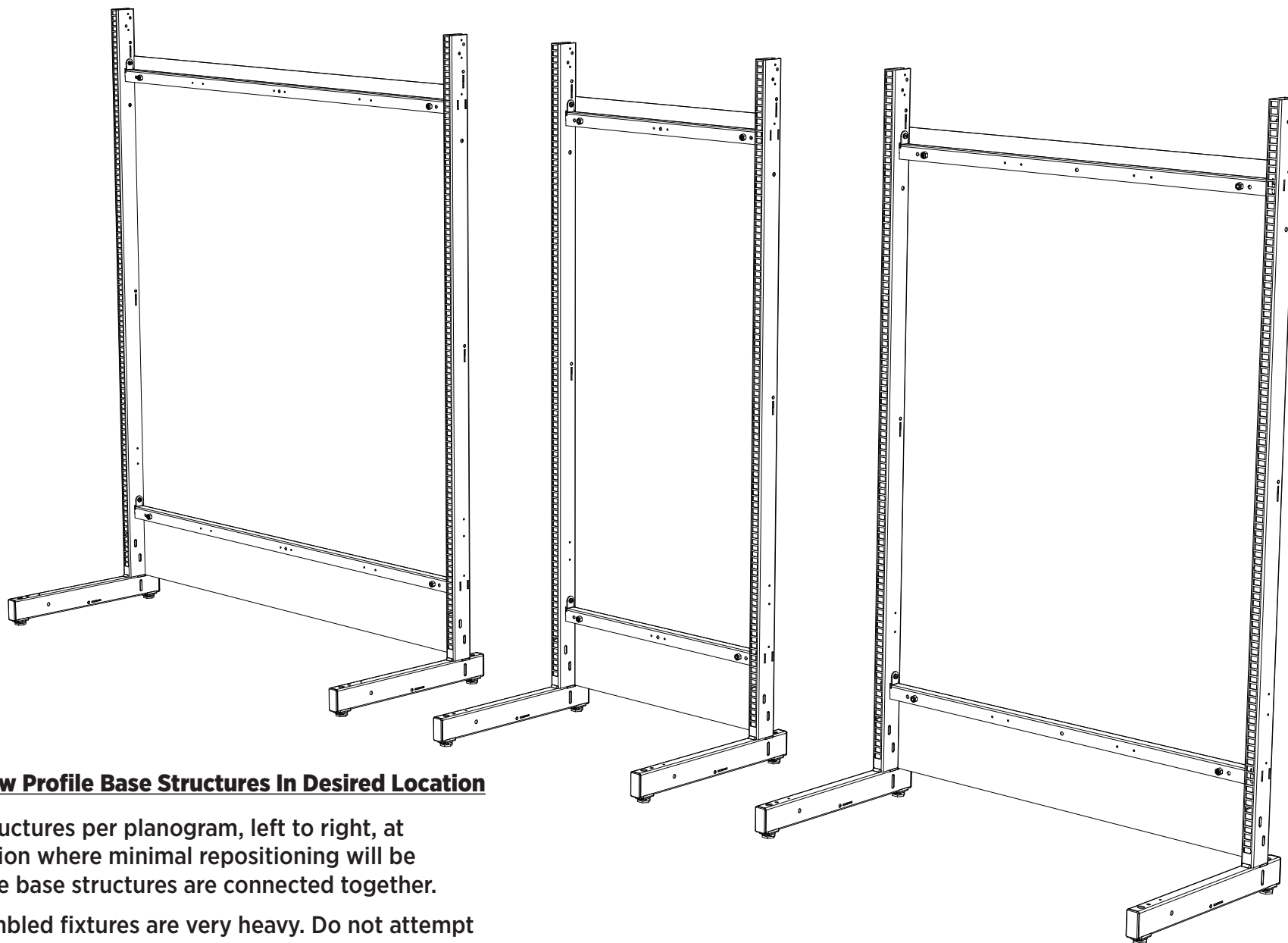

STEP 3: Place Low Profile Base Structures In Desired Location

Arrange base structures per planogram, left to right, at installation location where minimal repositioning will be required once the base structures are connected together.

CAUTION! Assembled fixtures are very heavy. Do not attempt to lift or move without assistance.

THE MANUFACTURER OF THIS MERCHANDISING SYSTEM ASSUMES NO LIABILITY FOR INJURY, DAMAGE OR LOSS OF PROPERTY AS A RESULT OF IMPROPER ASSEMBLY, INSTALLATION, AND/OR USE OF THIS DISPLAY.

Install Structure - 2.2

STEP 4: Connect Low Profile Base Structures Together

- Connect adjacent horizontal legs together using **(DETAIL 4A)**:
 - (1) #1/4-20 x 2.750" Phillips Pan Head Machine Screw
 - (2) 1/4" External Tooth Lock Washers
 - (2) 1/4" x 0.625" OD Flat Washers
 - (1) #1/4-20 Wing Nut
- Connect adjacent slotted uprights together in the same manner **(DETAIL 4B)**:
 - (1) #1/4-20 x 2.750" Phillips Pan Head Machine Screw
 - (2) 1/4" External Tooth Lock Washers
 - (2) 1/4" x 0.625" OD Flat Washers
 - (1) #1/4-20 Wing Nut
- Repeat hardware installation as required.

DETAIL 4A
ADJACENT HORIZONTAL LEGS
HARDWARE DIAGRAM

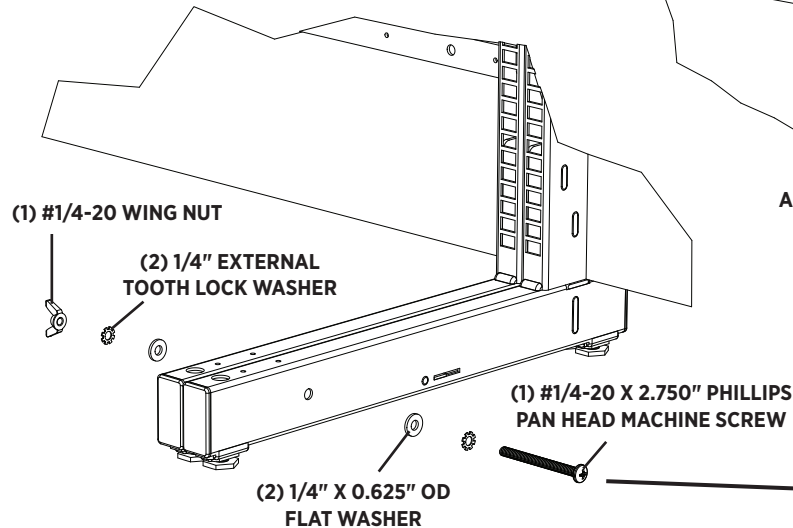

DETAIL 4B
ADJACENT SLOTTED UPRIGHTS
FINAL ASSEMBLY

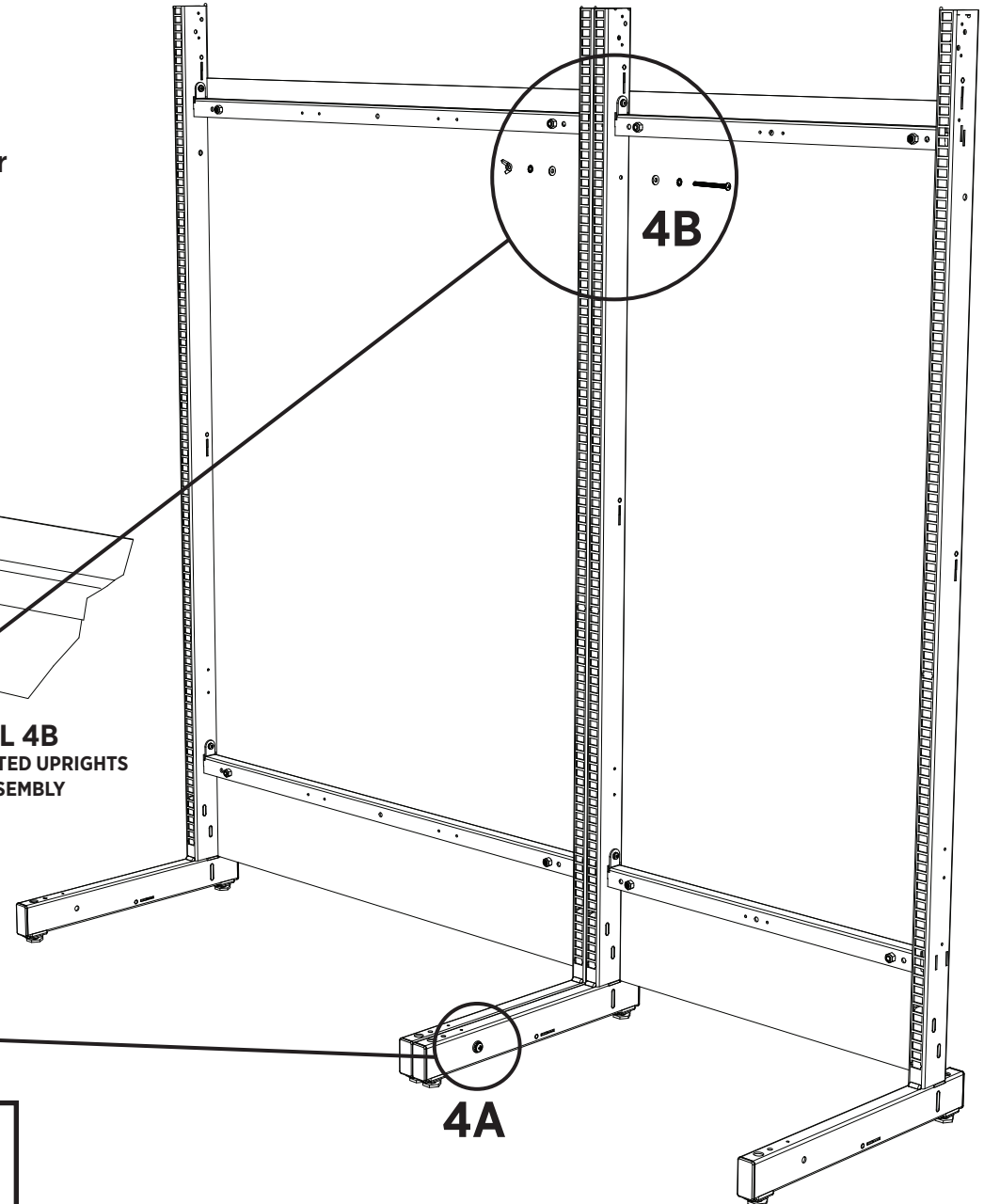
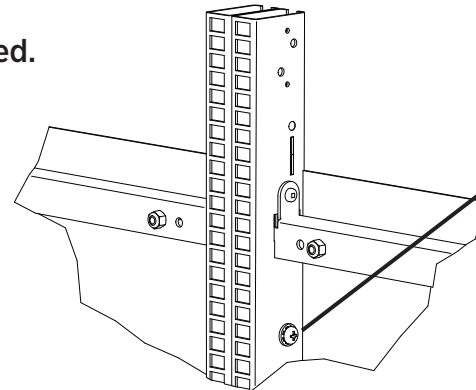

THE MANUFACTURER OF THIS MERCHANDISING SYSTEM ASSUMES NO LIABILITY FOR INJURY, DAMAGE OR LOSS OF PROPERTY AS A RESULT OF IMPROPER ASSEMBLY, INSTALLATION, AND/OR USE OF THIS DISPLAY.

Install Structure - 2.3

STEP 5: Level & Align Low Profile Base Structure Assembly

Use the hex end of an Anti-Tip Floor Mounting Bracket as a wrench to adjust levelers located at the front and back each support leg, as shown.

Use bubble level in each section of display to check that the entire structure is level front to back, horizontally and vertically.

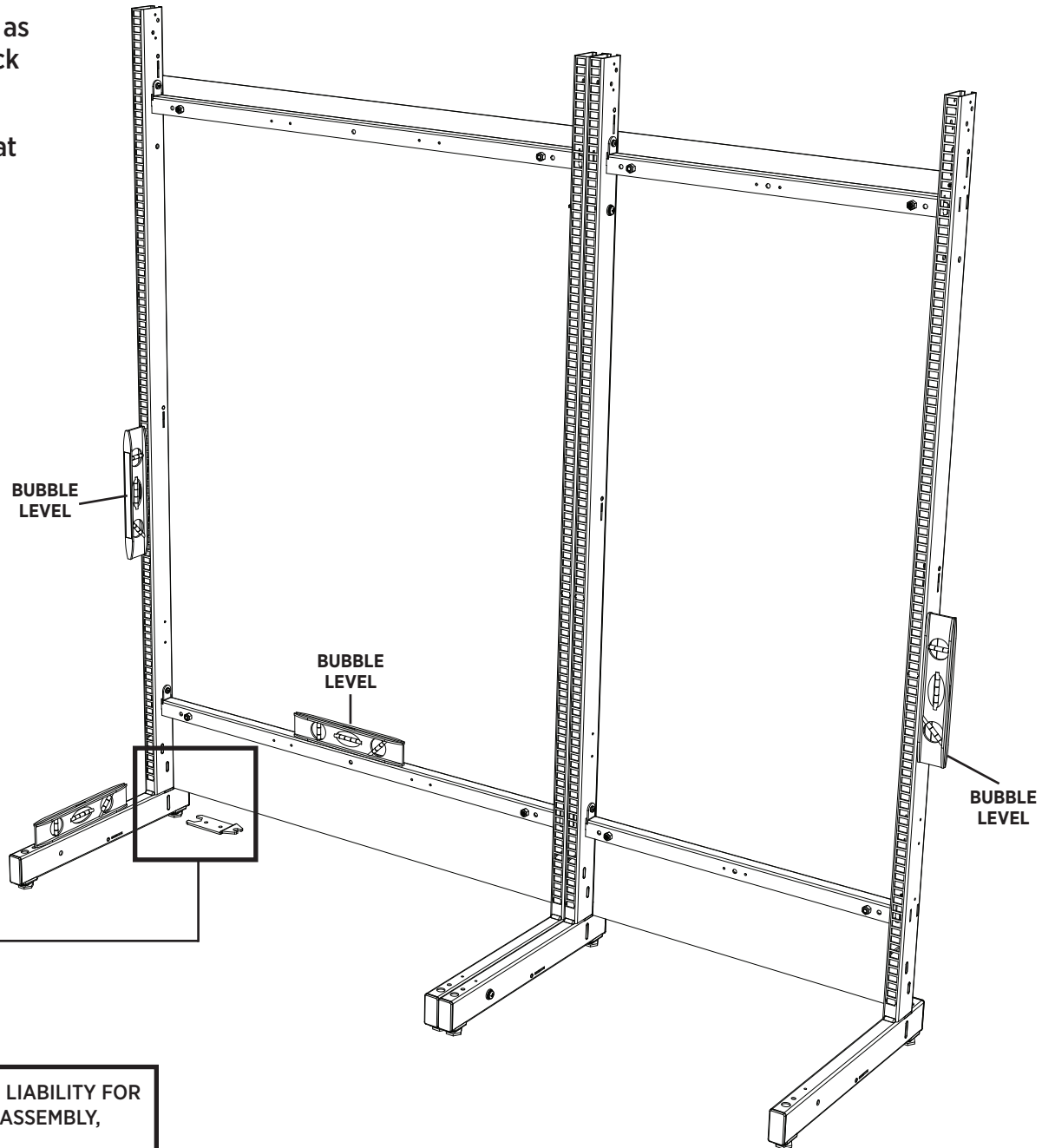
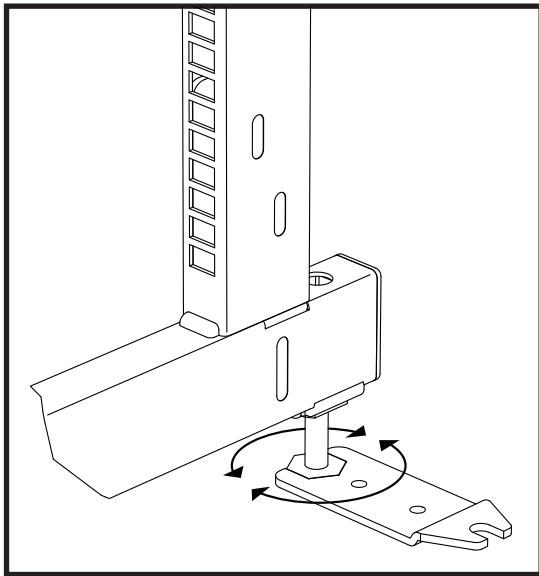
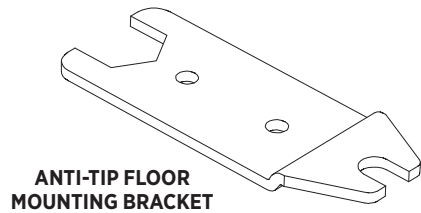

THE MANUFACTURER OF THIS MERCHANDISING SYSTEM ASSUMES NO LIABILITY FOR INJURY, DAMAGE OR LOSS OF PROPERTY AS A RESULT OF IMPROPER ASSEMBLY, INSTALLATION, AND/OR USE OF THIS DISPLAY.

Install Structure - 2.4

STEP 6: Install Anti-Tip Floor Brackets To Base Structure

For safety and stability, Anti-Tip Floor Mounting Brackets must be installed over every leveler in the base structural assembly. **Refer to DETAIL 6A for correct placement and positioning of Anti-Tip Floor Mounting Brackets.**

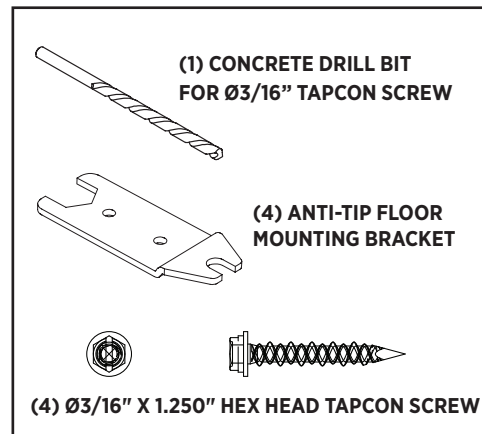
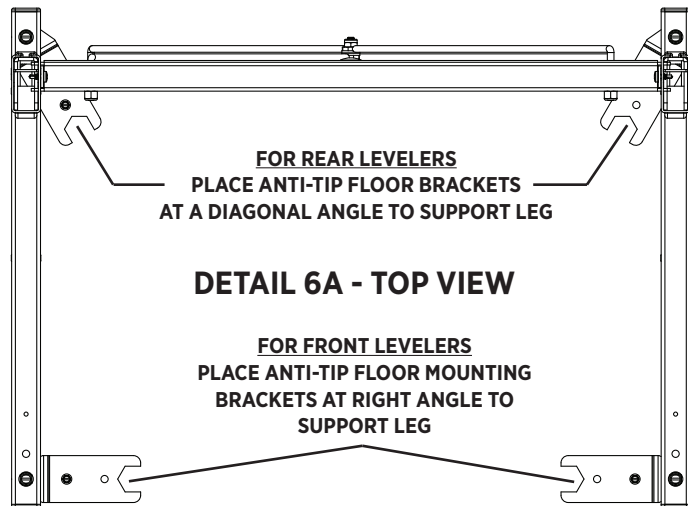

- Use the provided 3/16" concrete drill bit. Place one (1) Anti-Tip Floor Bracket over leveler, using one of the holes as a guide to drill a 1.25" deep hole into concrete floor.
- Install one (1) Ø3/16" x 1.250" Tapcon Screw through hole in bracket and into concrete floor.
- Use a 1/4" hex driver to drive Tapcon Screws into concrete floor.
- Repeat installation over all levelers in structural assembly.

THE MANUFACTURER OF THIS MERCHANDISING SYSTEM ASSUMES NO LIABILITY FOR INJURY, DAMAGE OR LOSS OF PROPERTY AS A RESULT OF IMPROPER ASSEMBLY, INSTALLATION, AND/OR USE OF THIS DISPLAY.

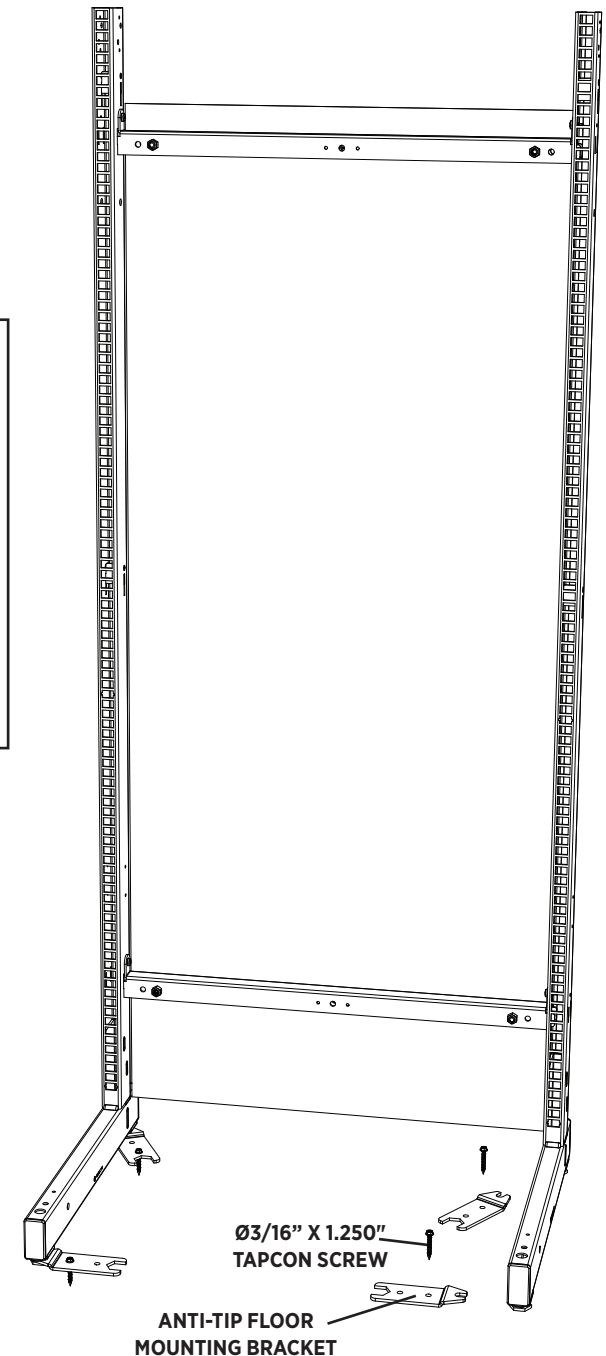

Install Structure - 2.5

STEP 7: Assemble And Install Wall Mount Brackets

For safety and stability, Wall Mount Brackets must be attached to the base unit at the far left and far right vertical leg uprights, and to one of the vertical legs at each location where two vertical legs have been connected together throughout the assembly.

- Measure the distance from vertical leg uprights to the wall, and determine bracket assembly needed to span the gap. Preassemble the required number of bracket sets prior to installation.

ASSEMBLY #1: IF VERTICAL LEG UPRIGHT IS 2.5" - 11" FROM WALL

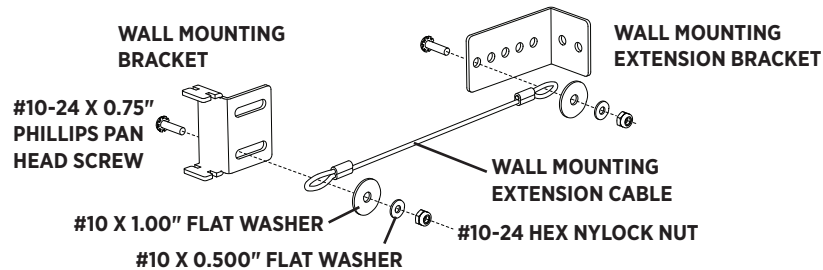

ASSEMBLY #2: IF VERTICAL LEG UPRIGHT IS 1" - 2.5" FROM WALL

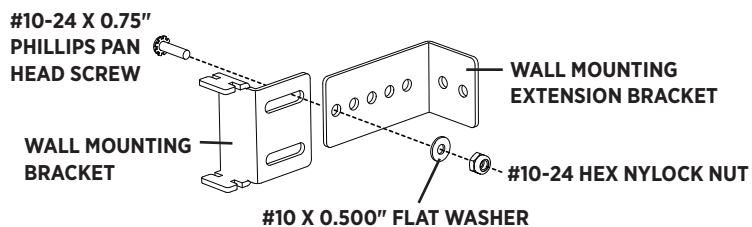

ASSEMBLY #3: IF VERTICAL LEG UPRIGHT IS 0" - 1" FROM WALL

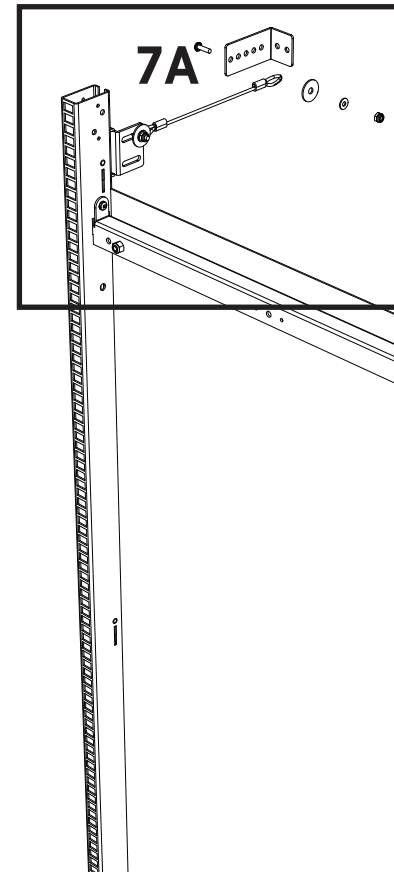
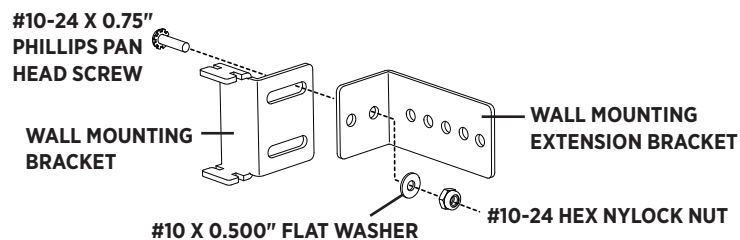

MOUNTING HARDWARE THAT CONNECTS THIS KIT TO THE WALL STRUCTURE IS NOT INCLUDED

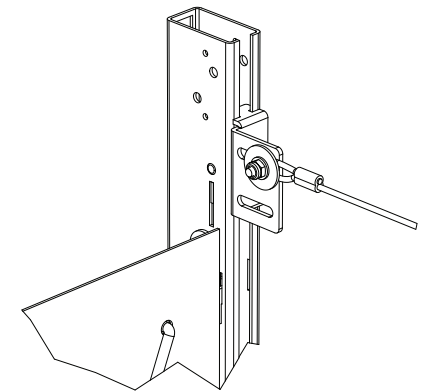

DETAIL 7A
SHOWING WALL
MOUNTING BRACKET
INSTALLED IN
VERTICAL LEG

- Slide bracket assemblies into the open channel on back side of far left & far right leg uprights and into one leg of each connected leg pair (**DETAIL 7A**).
- **IMPORTANT:** Wall mounting screws and related hardware are NOT included in this kit. Determine the correct wall mounting hardware that will secure the Wall Mount Bracket assemblies to the existing wall type at installation location to securely support the structural assembly. Install wall mounting hardware as required.

THE MANUFACTURER OF THIS MERCHANDISING SYSTEM ASSUMES NO LIABILITY FOR INJURY, DAMAGE OR LOSS OF PROPERTY AS A RESULT OF IMPROPER ASSEMBLY, INSTALLATION, AND/OR USE OF THIS DISPLAY.

Install Structure - 2.6

STEP 8: Install Standard Extensions Onto Low Profile Base Structure Assembly

After the Low Profile Base Structure has been secured to the floor and wall, install Standard Extensions.

- Begin at one end of the Base Structure, and carefully slide bayonets of each corresponding width Standard Extension into the open top of each leg upright.
- **IMPORTANT:** Make sure that backer panel on the Standard Extension **slides behind** the backer panel on Base Structure (**DETAIL 8**).

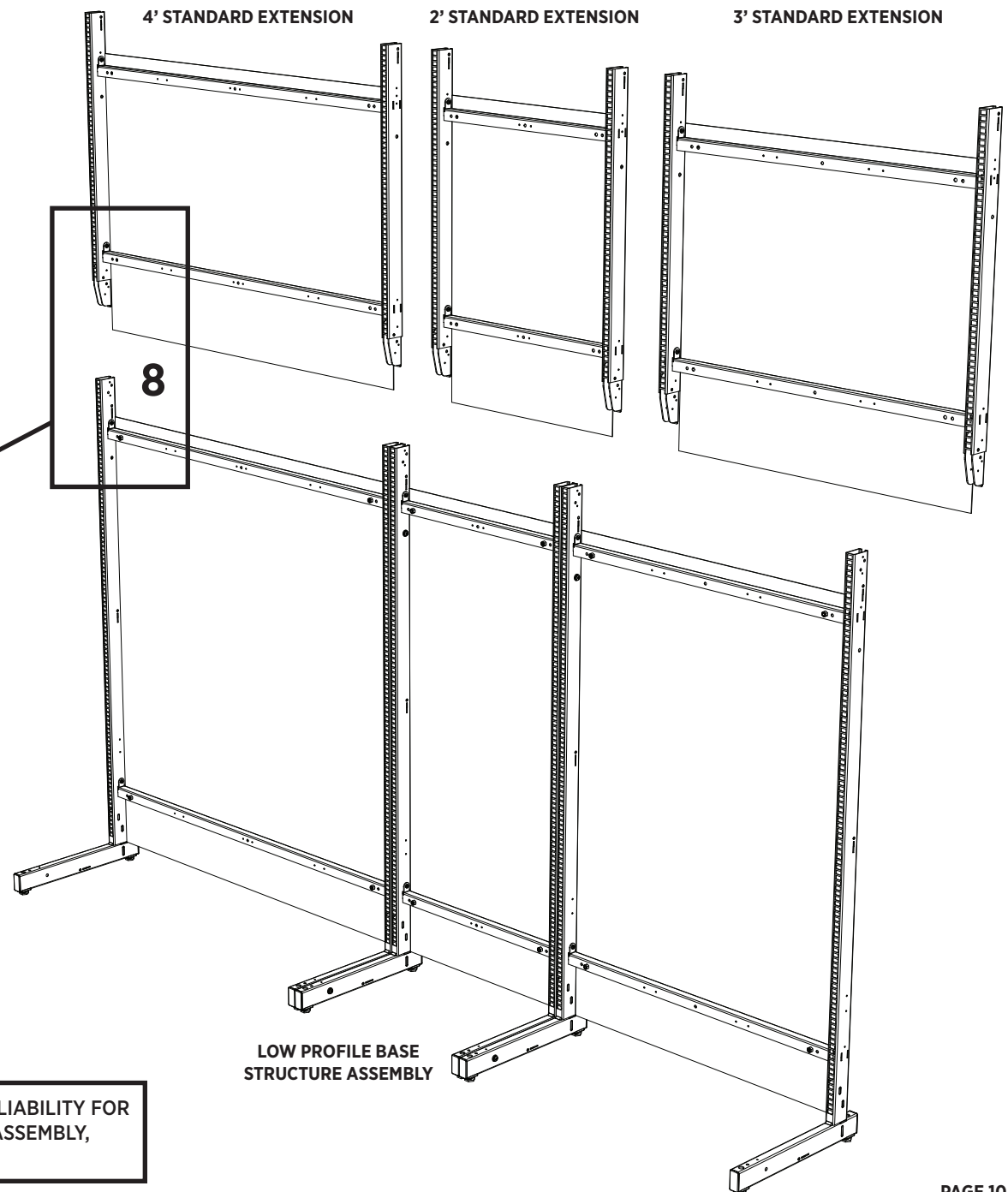
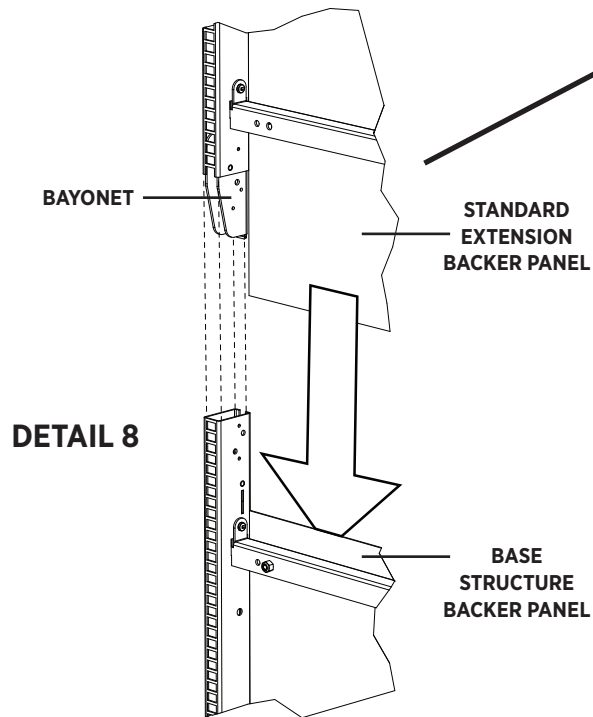

THE MANUFACTURER OF THIS MERCHANDISING SYSTEM ASSUMES NO LIABILITY FOR INJURY, DAMAGE OR LOSS OF PROPERTY AS A RESULT OF IMPROPER ASSEMBLY, INSTALLATION, AND/OR USE OF THIS DISPLAY.

Install Structure - 2.7

STEP 9: Secure Standard Extensions To Low Profile Base Structure

- Note location of screw holes in sides of slotted leg uprights. Install two (2) #10 x 0.500" Square Drive TEK Screws into holes in slotted leg upright at each connection point where the Standard Extensions have been inserted into the Low Profile Base Structure (**DETAIL 9**).
- Repeat above step as required throughout the Structural Assembly.

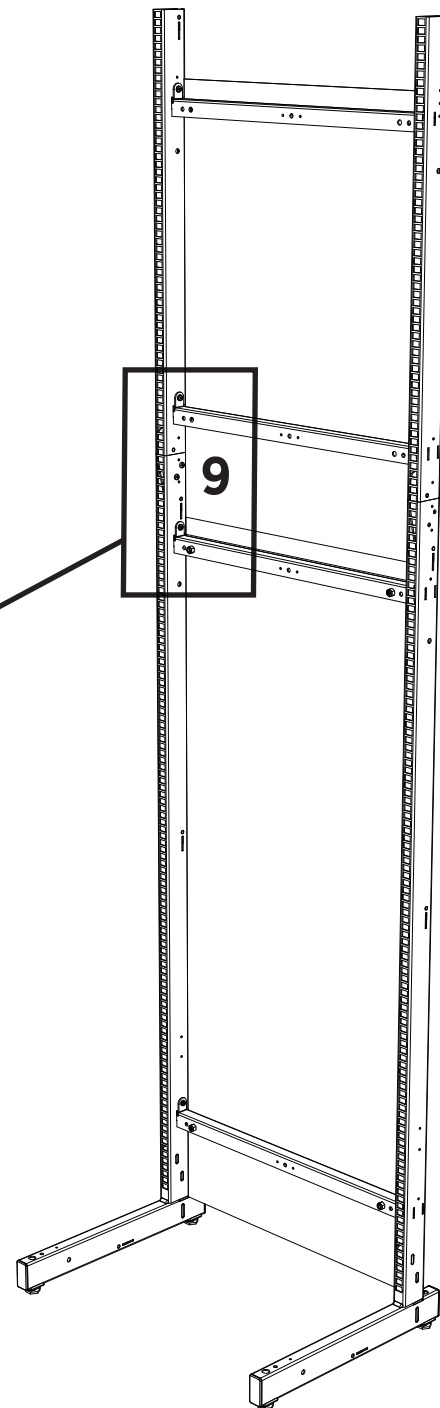
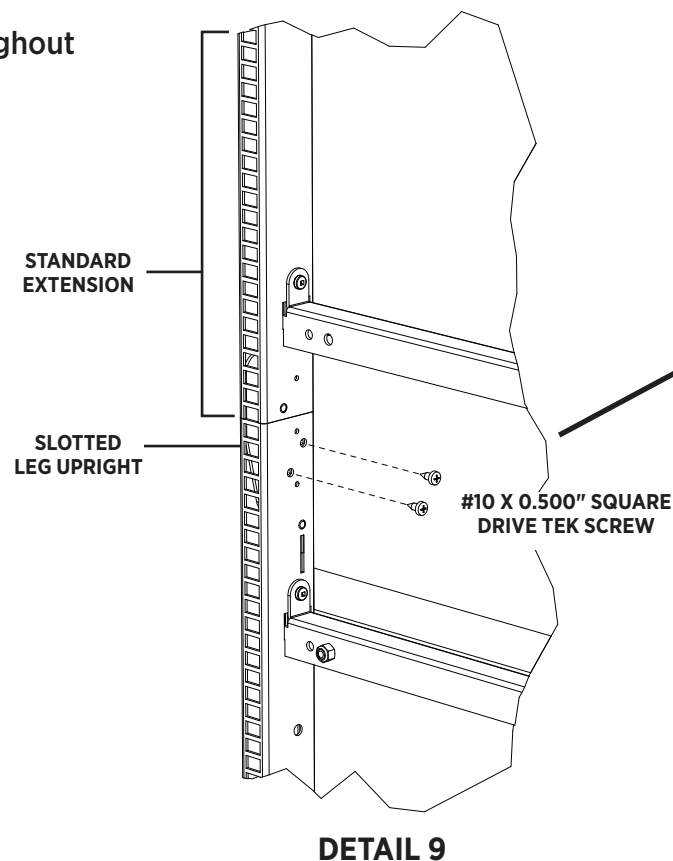
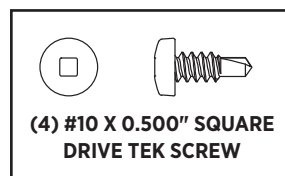

THE MANUFACTURER OF THIS MERCHANDISING SYSTEM ASSUMES NO LIABILITY FOR INJURY, DAMAGE OR LOSS OF PROPERTY AS A RESULT OF IMPROPER ASSEMBLY, INSTALLATION, AND/OR USE OF THIS DISPLAY.

Install Structure - 2.8

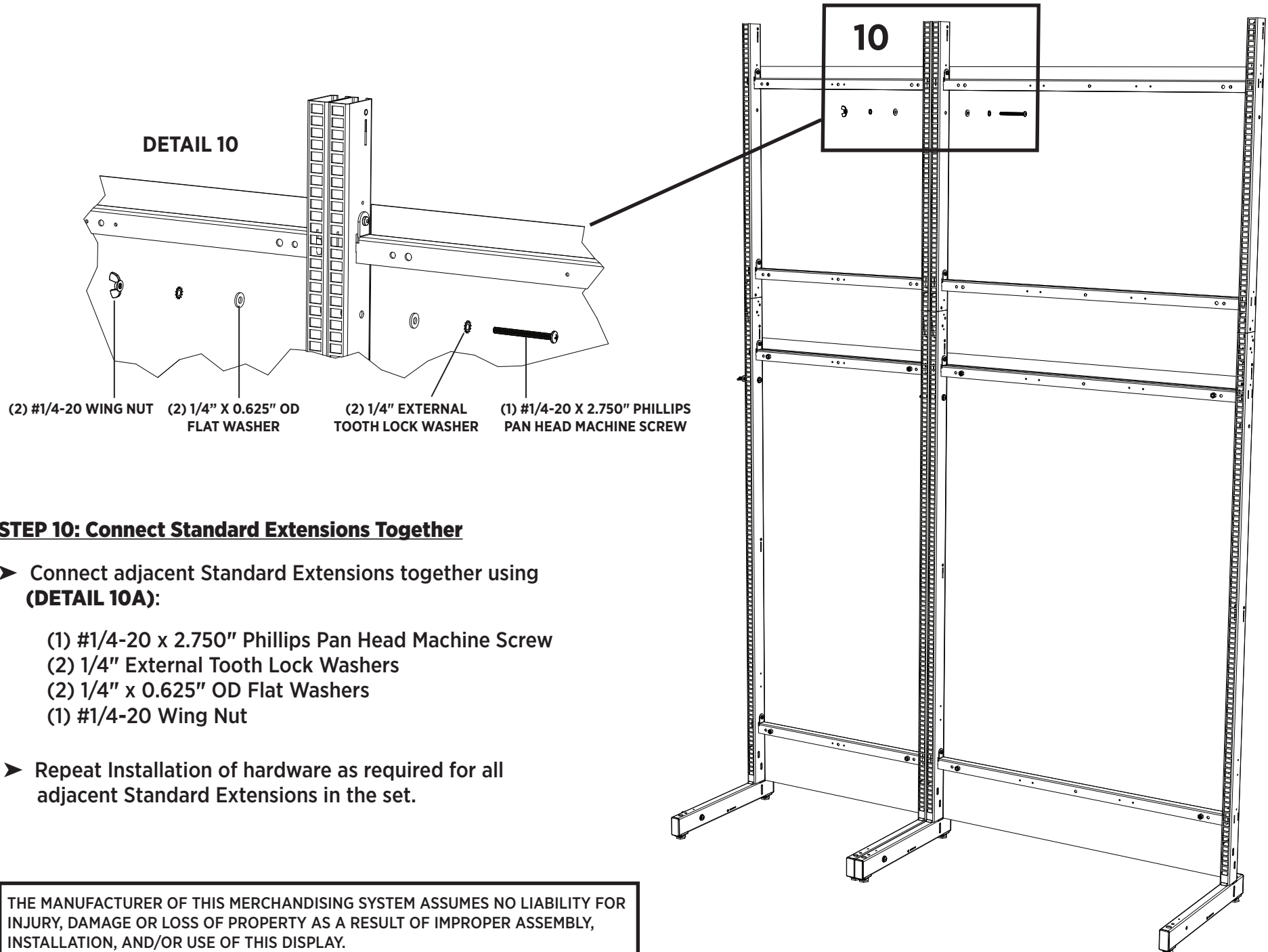

Install Top Sign - 3.1

STEP 11: Top Sign Installation

Identify Top Sign Components and Hardware:

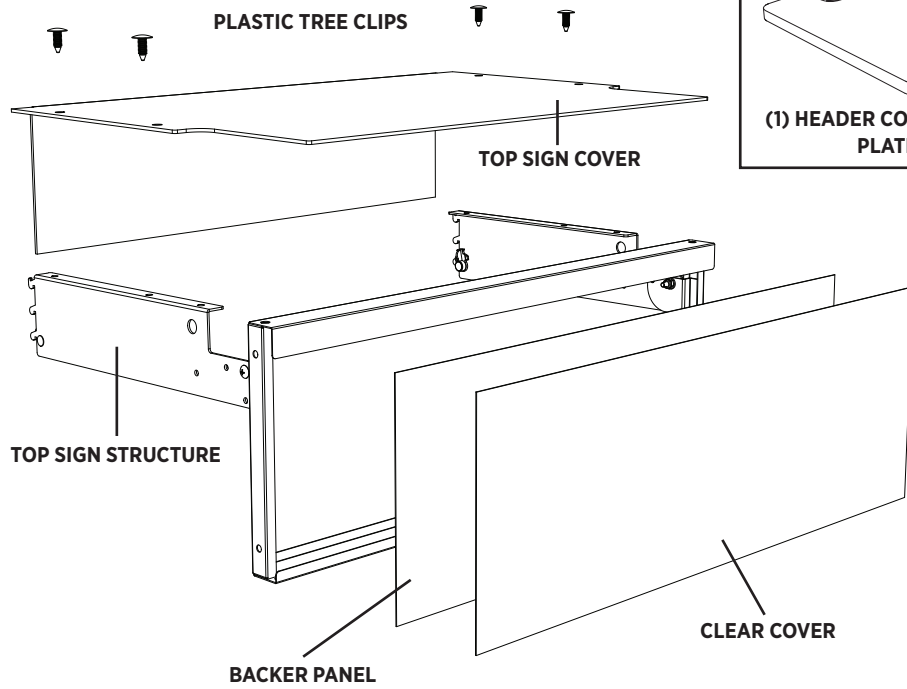

HARDWARE BAG CONTENTS:

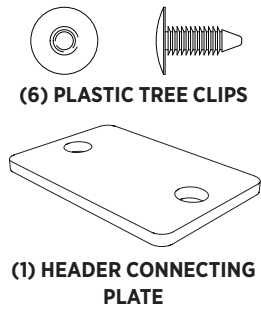

DETAIL 11A

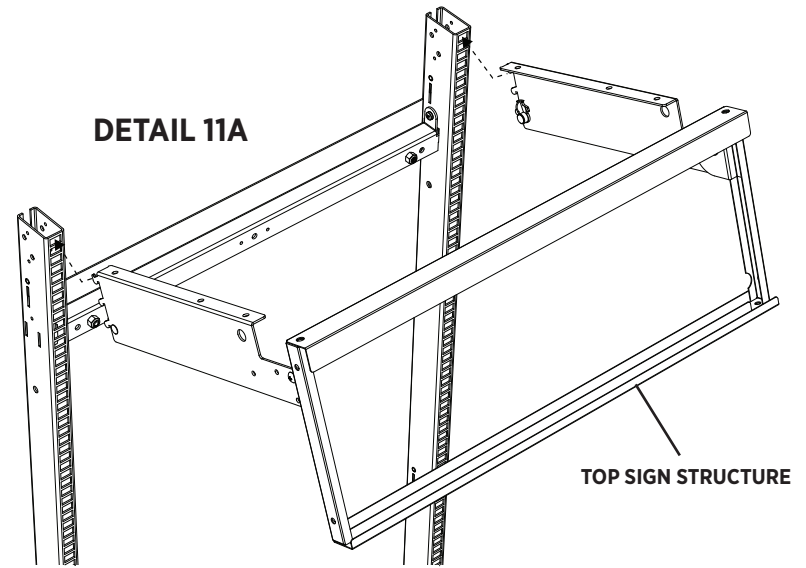

DETAIL 11B

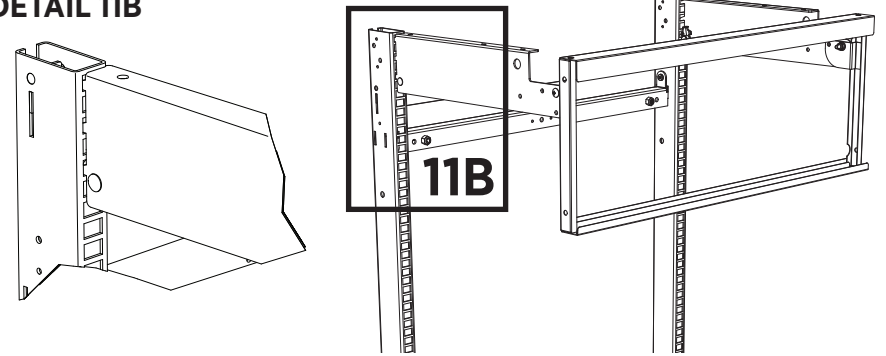

DETAIL 11C

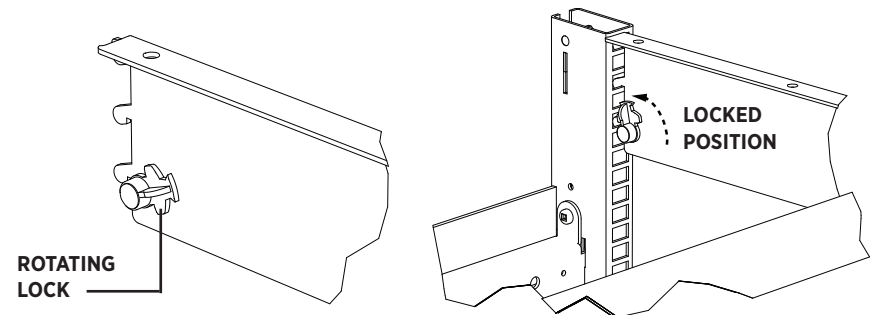

Attach Top Sign Structure to Standard Extension.

- Remove Backer Panel and Clear Cover from Top Sign Frame
- Place top hook on the Top Sign Structure hanging bracket into the top slot of Extension uprights (**DETAIL 11A**). Pivot Top Sign downward and engage remaining hooks in slotted uprights (**DETAIL 11B**) and push downward to secure.
- Lock Top Sign Structure into place by engaging both rotating locks into slots in vertical uprights (**DETAIL 11C**).

THE MANUFACTURER OF THIS MERCHANDISING SYSTEM ASSUMES NO LIABILITY FOR INJURY, DAMAGE OR LOSS OF PROPERTY AS A RESULT OF IMPROPER ASSEMBLY, INSTALLATION, AND/OR USE OF THIS DISPLAY.

Install Top Sign - Top Cover - 3.2

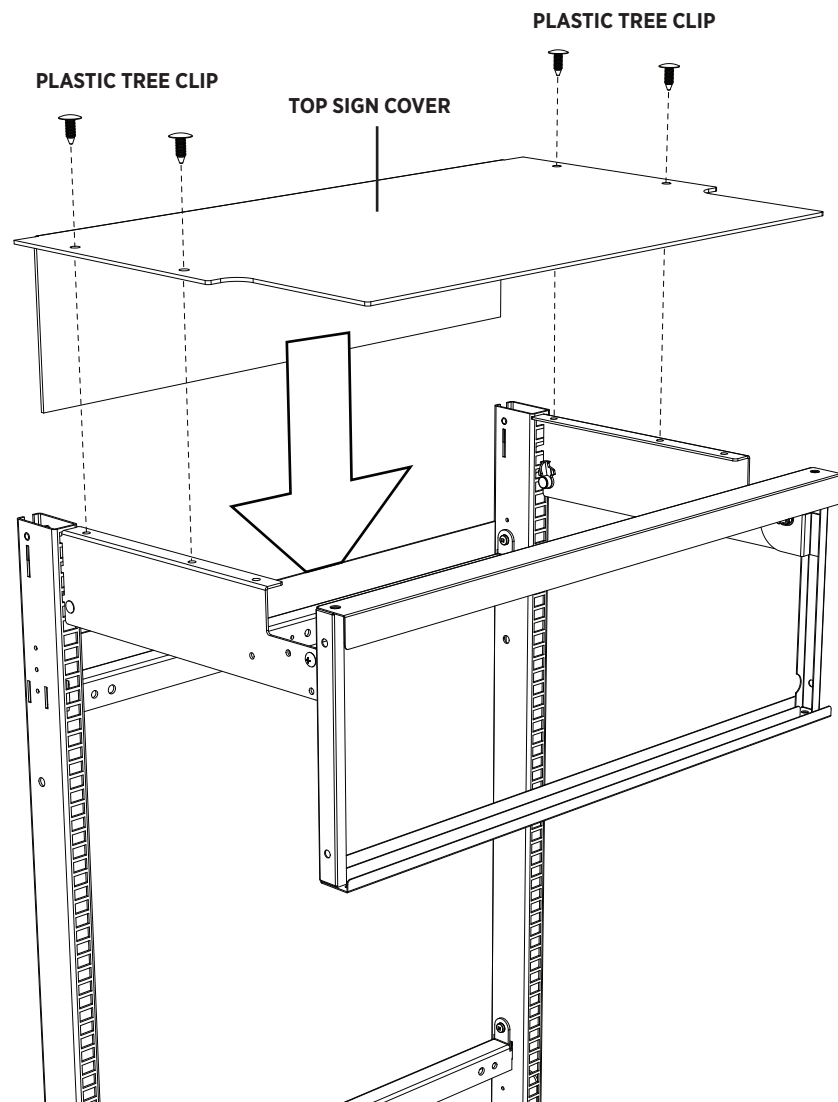

STEP 12: Attach Top Cover Onto Top Sign Structure

- Align Top Sign Cover over side brackets of Top Sign and lower into place.
- Slide the back panel of Top Sign Cover behind the back panel on Standard Extension.
- Align holes in Top Sign Cover over holes in Top Sign hanging brackets. Install four (4) Plastic Tree Clips.
- Repeat installation for all Top Signs in the set.



THE MANUFACTURER OF THIS MERCHANDISING SYSTEM ASSUMES NO LIABILITY FOR INJURY, DAMAGE OR LOSS OF PROPERTY AS A RESULT OF IMPROPER ASSEMBLY, INSTALLATION, AND/OR USE OF THIS DISPLAY.

Install Top Sign - 3.3

STEP 13: Connect Top Signs Together

Connect Adjacent Top Sign Structures Together For Added Stability.

- Install header connecting plate between adjacent Top Signs. Align holes in connecting plate over front pair of holes on Top Sign brackets, as shown, and install two tree clips to secure. **(DETAIL 13).**
- Repeat as required throughout fixture assembly.

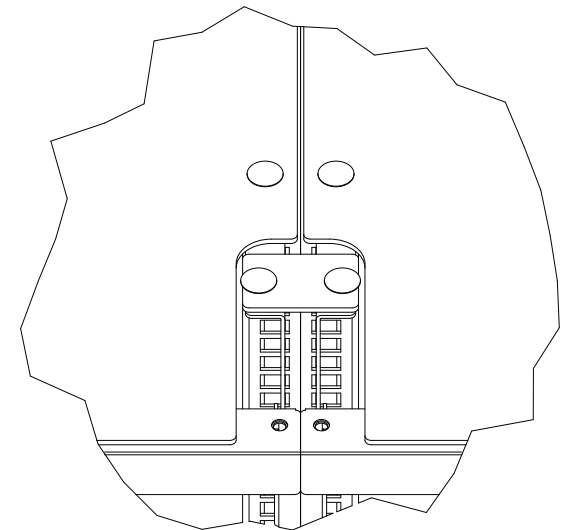
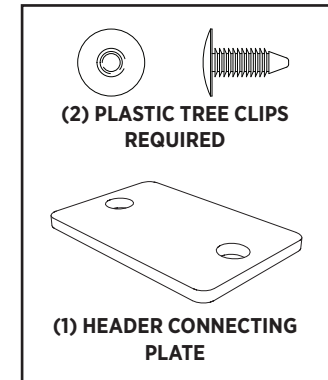
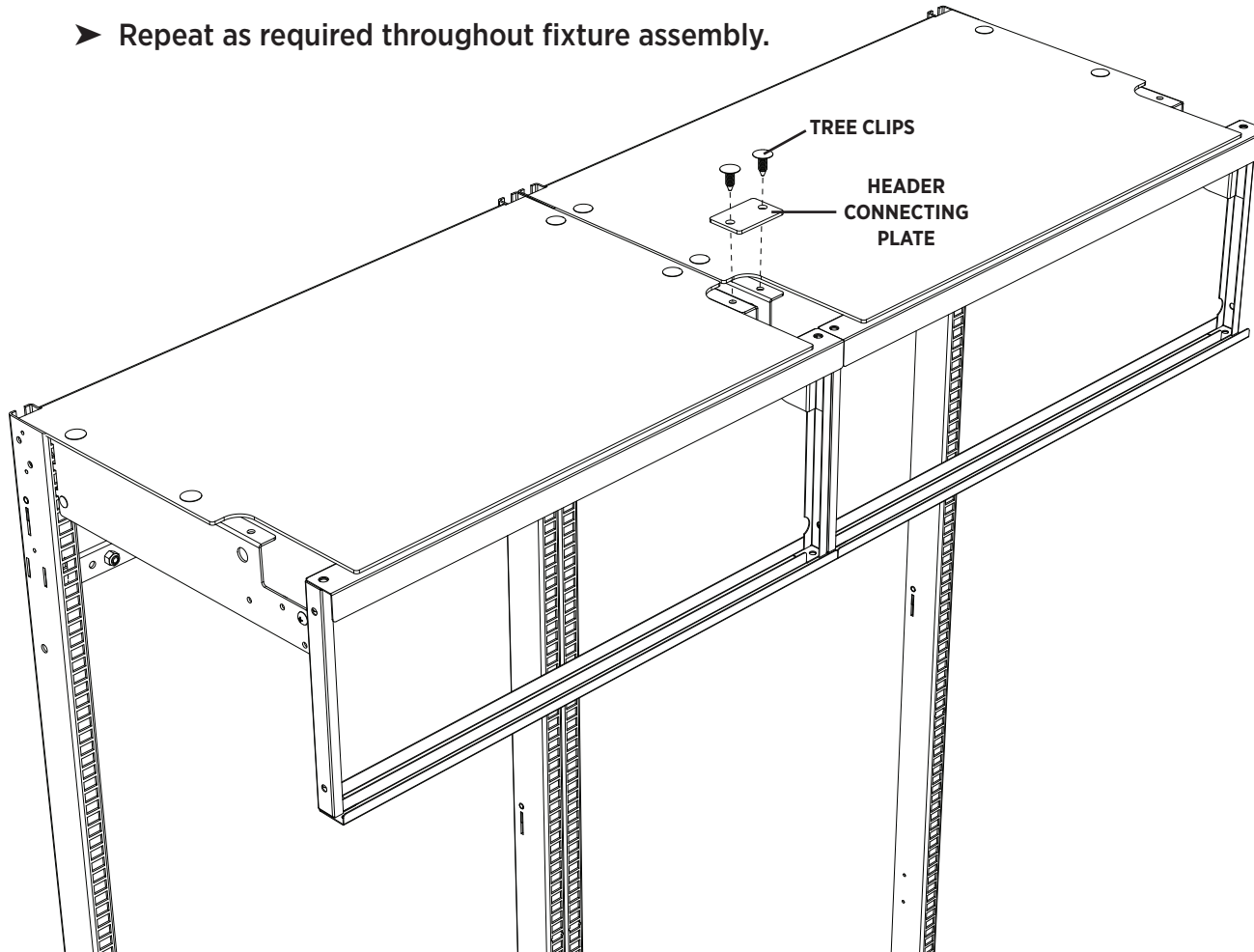

DETAIL 13
HARDWARE INSTALLED

THE MANUFACTURER OF THIS MERCHANDISING SYSTEM ASSUMES NO LIABILITY FOR INJURY, DAMAGE OR LOSS OF PROPERTY AS A RESULT OF IMPROPER ASSEMBLY, INSTALLATION, AND/OR USE OF THIS DISPLAY.

Install Illuminated Top Sign Panel - 3.4

STEP 14 (OPTIONAL ADD-ON): Illuminated Top Sign Panel Kit

Unpack and identify Illuminated Top Sign Panel components.

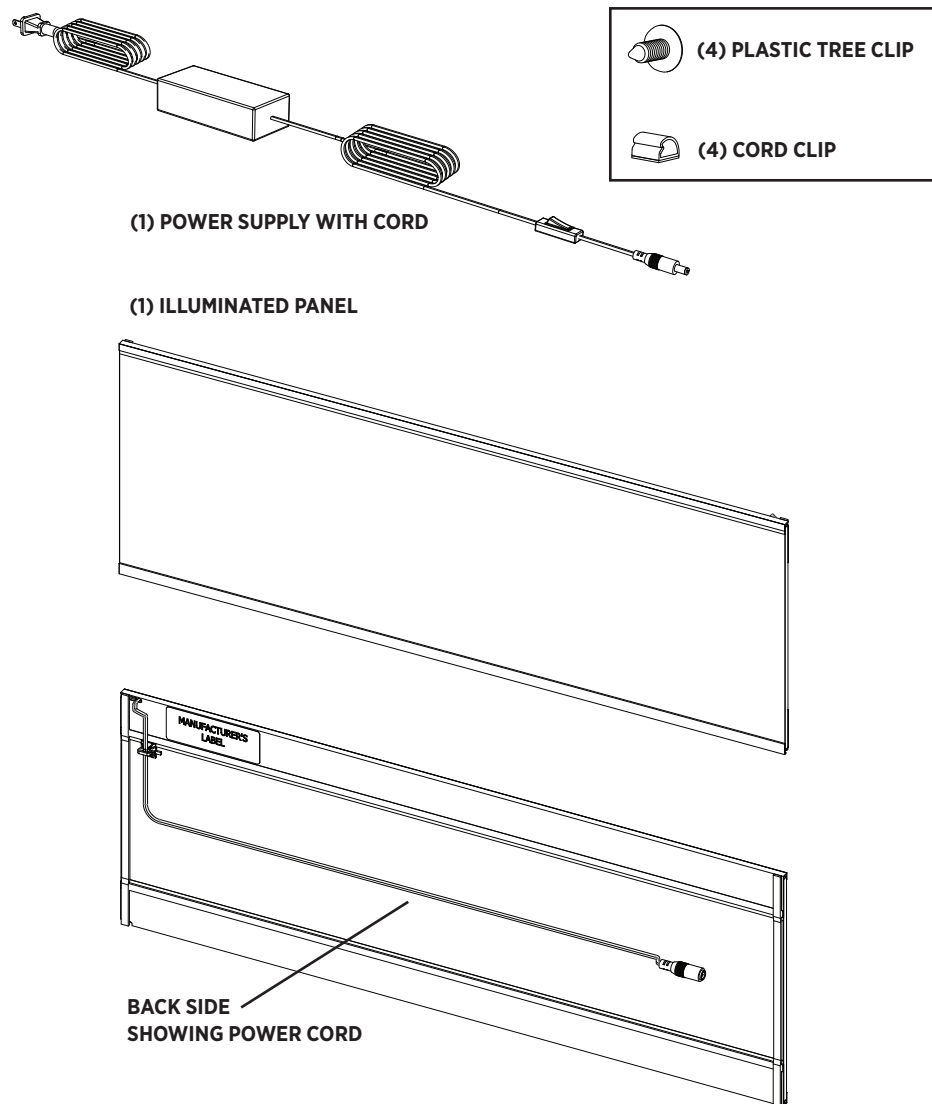

THE MANUFACTURER OF THIS MERCHANDISING SYSTEM ASSUMES NO LIABILITY FOR INJURY, DAMAGE OR LOSS OF PROPERTY AS A RESULT OF IMPROPER ASSEMBLY, INSTALLATION, AND/OR USE OF THIS DISPLAY.

STEP 15: Install Illuminated Top Sign Panel

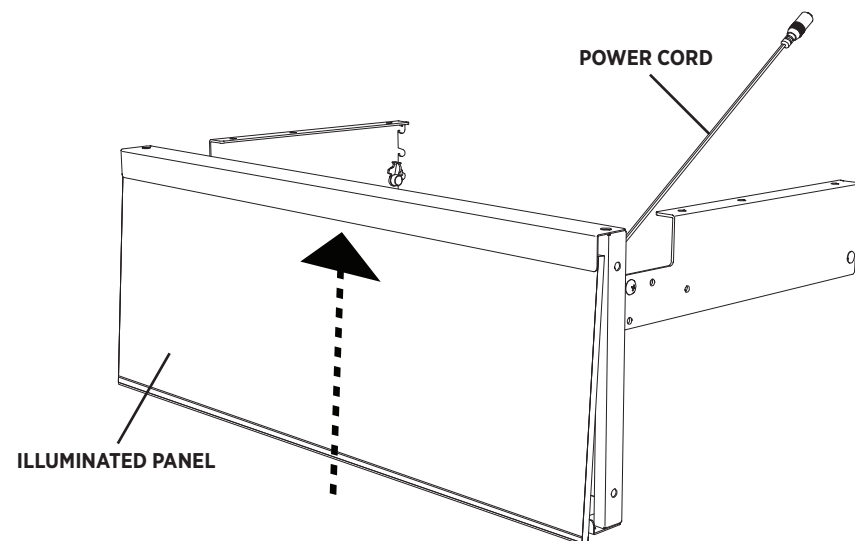

Feed power cord through front of sign frame, then lift and drop Illuminated Panel into Top Sign frame (**DETAIL 15**).

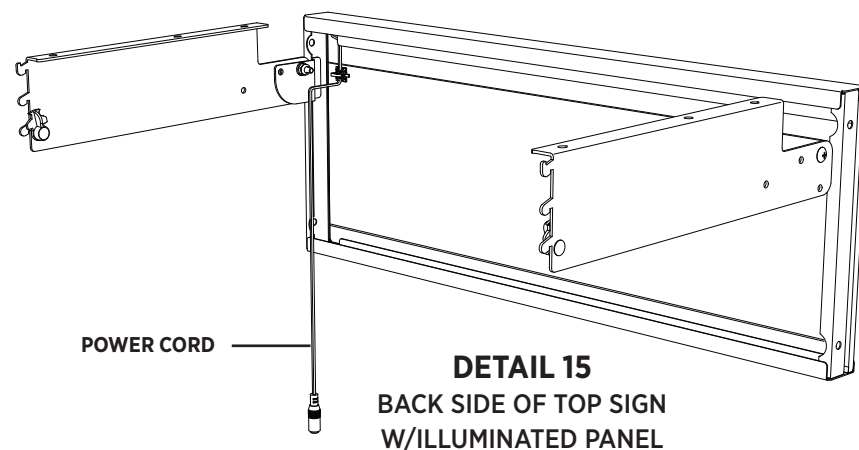

Install Illuminated Top Sign Panel and Top Sign Side Channels - 3.5

STEP 16: Install Cord Clips And Top Sign Side Channels

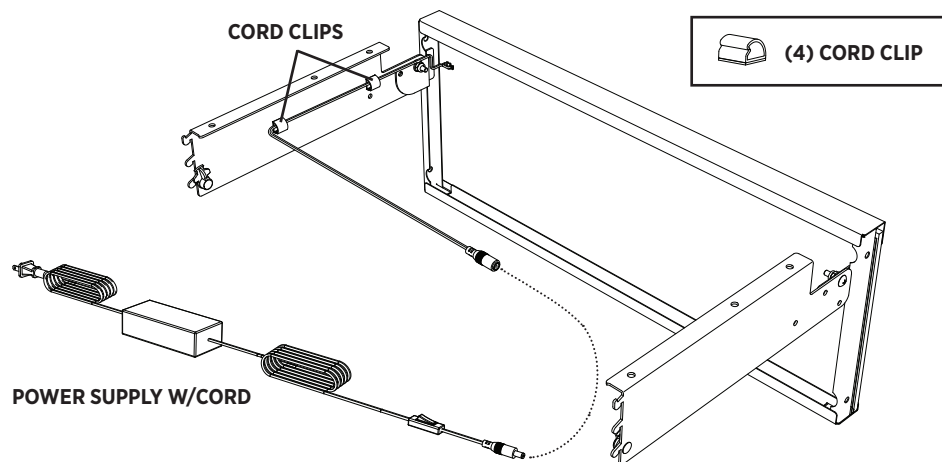

Use supplied Cord Clips to discipline cord on inside face of Top Sign Mounting Bracket. Attach cord to power supply, plug into nearest outlet.

STEP 17: Attach Top Sign Side Channels to Top Sign Frame

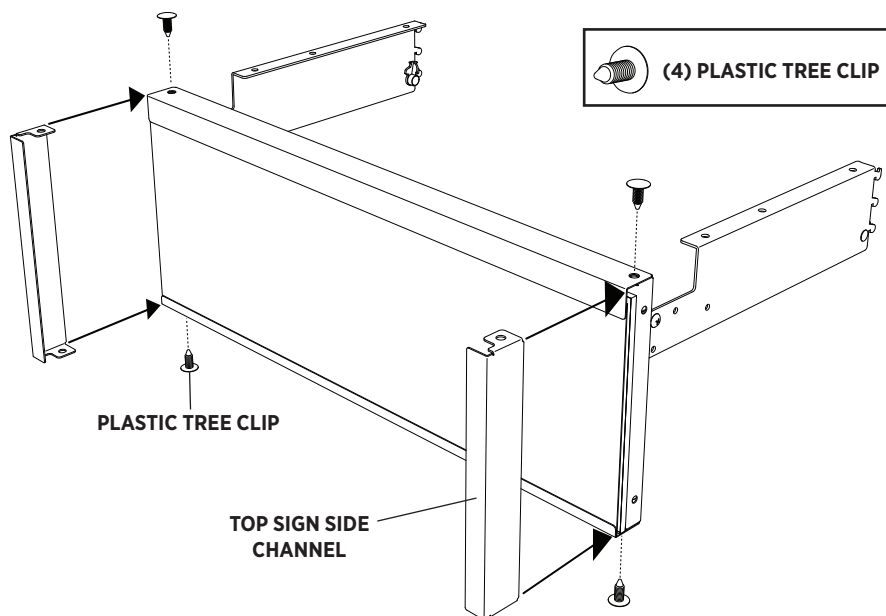

Attach two (2) Top Sign Side Channels to Top Sign Frame. Align holes in side channels over holes in Top Sign Frame and install (4) tree clips.

STEP 18: Installation of Panels and POS Graphic

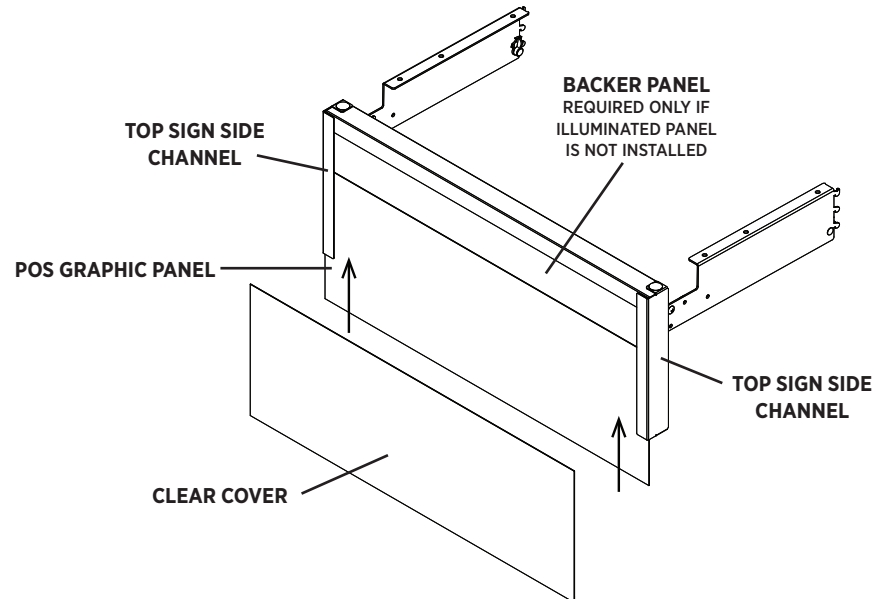

For non-illuminated sets only (when illuminated panel is not used):

- Insert backer panel (removed in Step 11) through bottom opening between side channels of Top Sign Frame.

Slide panel upward until it can be dropped into bottom channel of frame.

For non-illuminated and illuminated sets:

- Install POS graphic (not included) into Top Sign frame by sliding it through bottom opening between side channels of Top Sign Frame, as shown in diagram above.
- Peel protective film from both sides of clear cover and install it into Top Sign frame, in the same manner, so that it covers the POS graphic panel and holds it in place.

THE MANUFACTURER OF THIS MERCHANDISING SYSTEM ASSUMES NO LIABILITY FOR INJURY, DAMAGE OR LOSS OF PROPERTY AS A RESULT OF IMPROPER ASSEMBLY, INSTALLATION, AND/OR USE OF THIS DISPLAY.

STORAGE CABINET OPTION / SHELVES ONLY INSTALLATION - 4.1

IF STORAGE CABINETS ARE REQUIRED:

➤ Proceed to Step 19, page 19.

IMPORTANT INSTALLATION INFORMATION:

Carefully review all Storage Cabinet installation instructions, Steps 19 - 26, before starting assembly of Storage Cabinet components on the fixture assembly.

Install one Storage Cabinet at a time. Do not proceed with installation of adjacent Storage Cabinets until the first Cabinet is fully assembled. Components must be installed in the correct order before proceeding with installation of adjacent Storage Cabinets.

STORAGE CABINET
ASSEMBLY

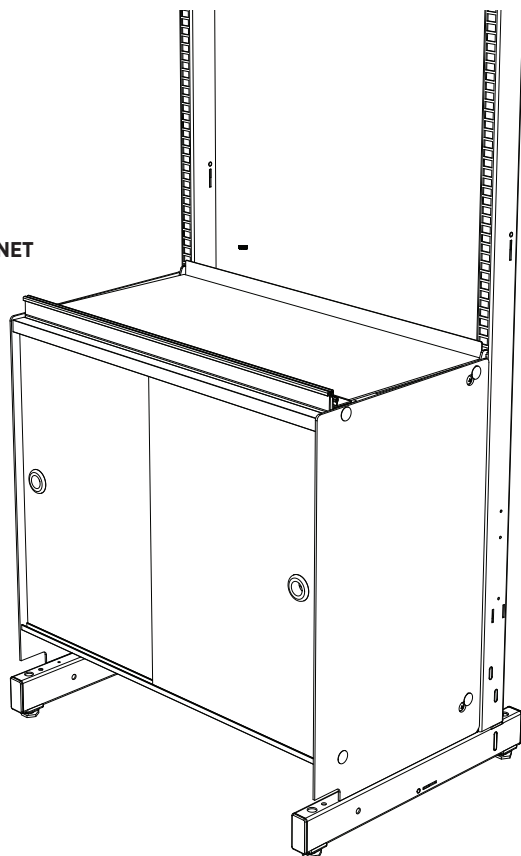

SHELF INSTALLATION, NO STORAGE CABINETS:

➤ Proceed to Step 27, page 24.

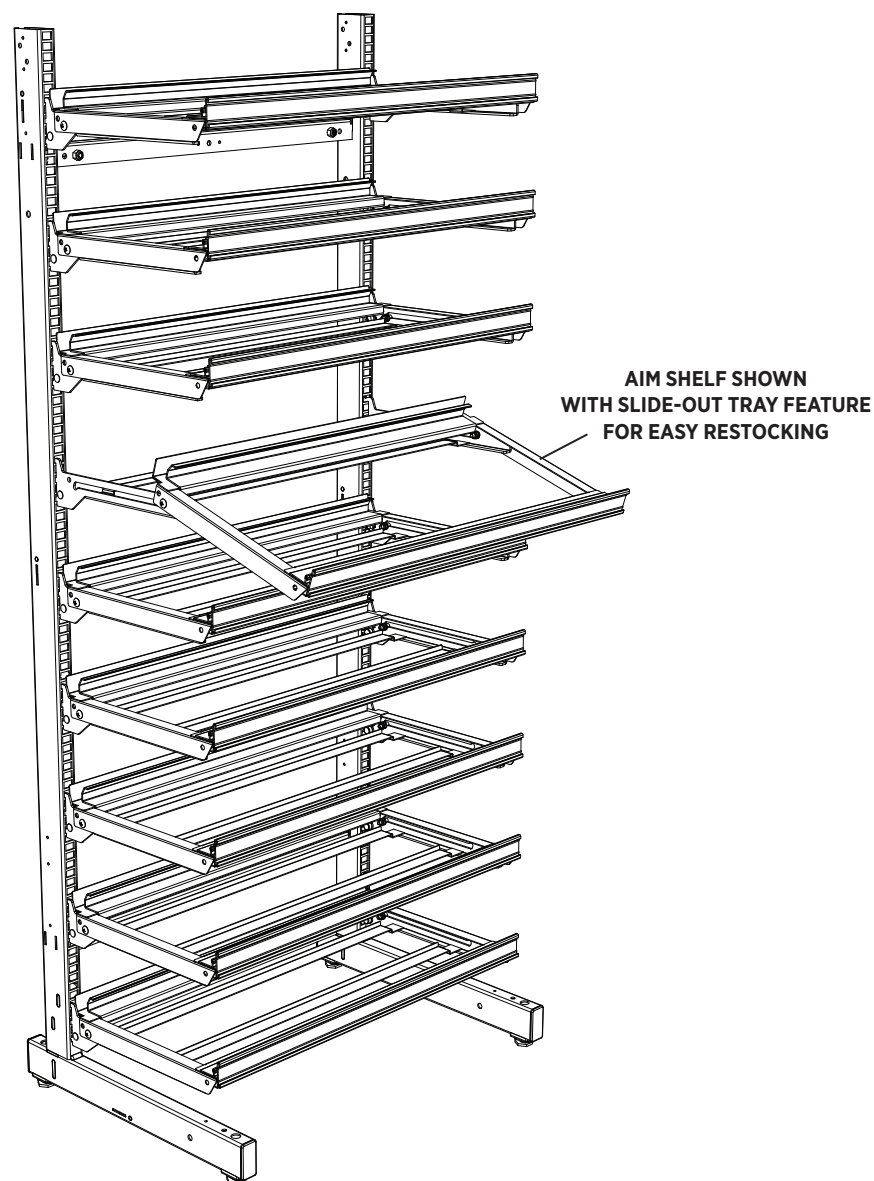

Storage Cabinet Installation - 5.1

STEP 19 (OPTIONAL ADD-ON): Storage Cabinet Components

Unpack and identify Storage Cabinet Kit components.

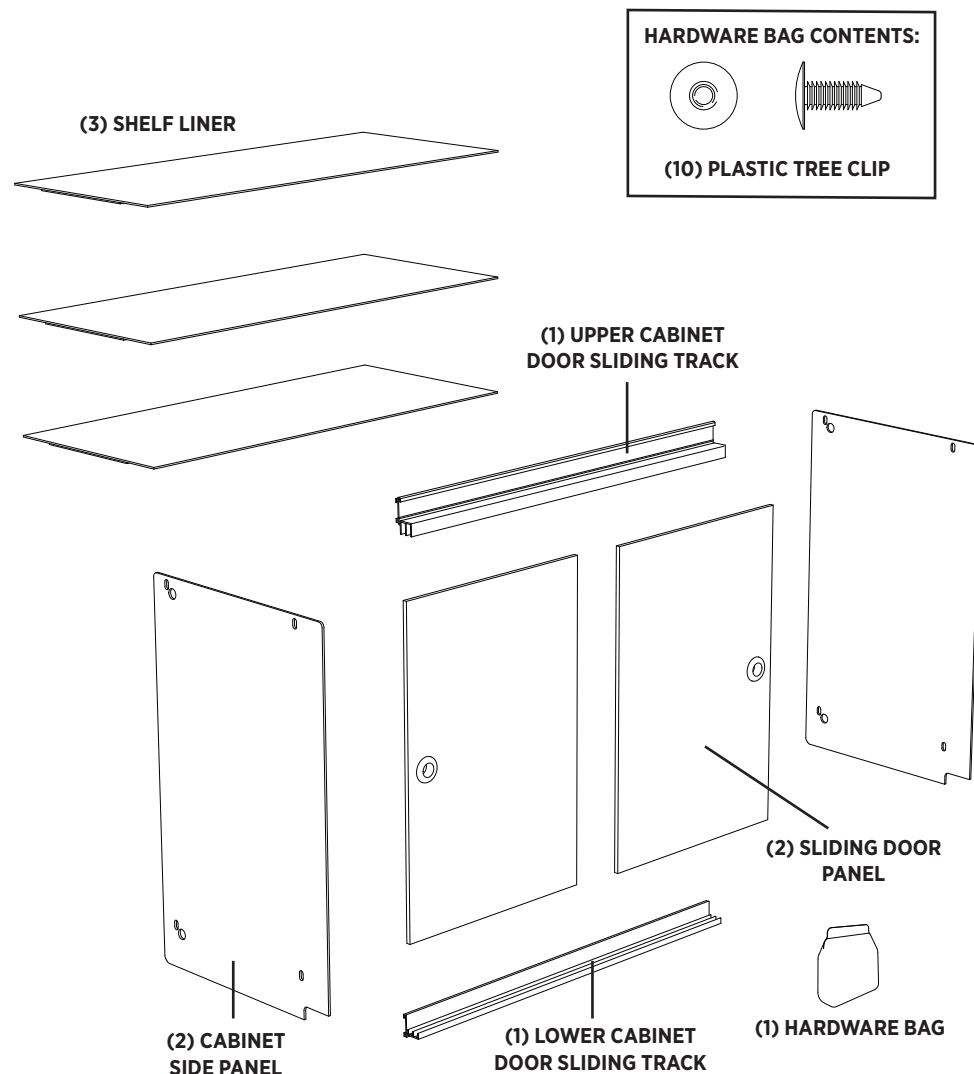

THE MANUFACTURER OF THIS MERCHANDISING SYSTEM ASSUMES NO LIABILITY FOR INJURY, DAMAGE OR LOSS OF PROPERTY AS A RESULT OF IMPROPER ASSEMBLY, INSTALLATION, AND/OR USE OF THIS DISPLAY.

STEP 20: Prepare Shelves For Cabinet Storage Assembly

- Two shelves are required to assemble each Storage Cabinet on the Low Profile Base Structure.
- An optional third shelf can be added for additional storage, but it must be installed on the fixture prior to assembly of Storage Cabinet(s).
- Rear Shelf Extrusions must be removed from all shelves used in Storage Cabinet assembly.
- Remove Rear Shelf Extrusion by flexing it toward the front of the shelf to disengage it from metal flange under shelf. Discard after removal.

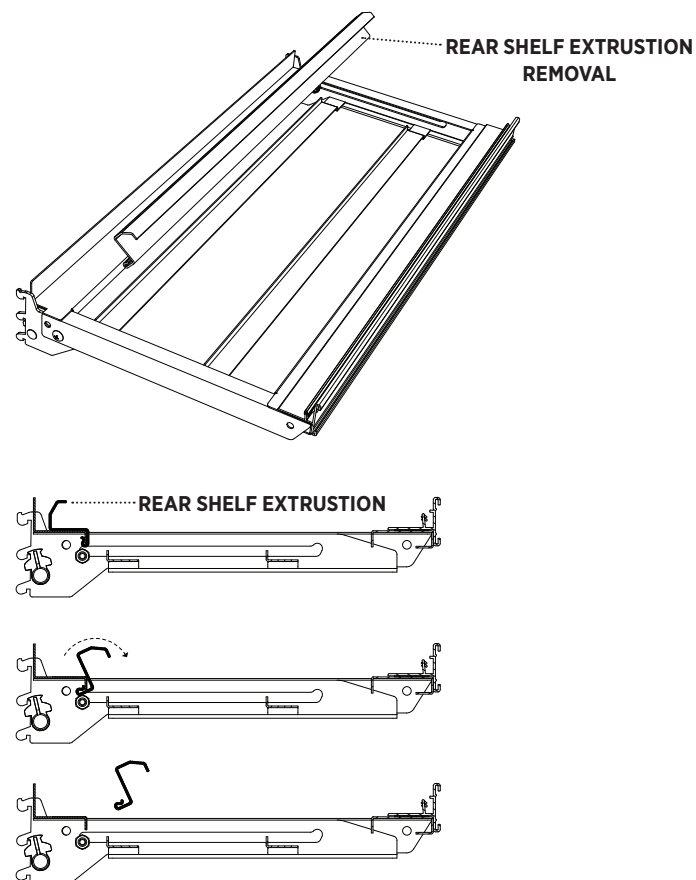

Storage Cabinet Installation - 5.2

STEP 21: Installing Shelves For Cabinet Storage

➤ **IMPORTANT INSTALLATION INFORMATION:**

Install one Storage Cabinet at a time, beginning with shelf installation outlined in this step. Do not proceed with installation of adjacent Storage Cabinets until the first Cabinet is fully assembled.

- Install Cabinet Storage shelves for first Cabinet on fixture. Locate two notched slots in each slotted upright (**DETAIL 21A**). The notches indicate upper and lower shelf placement for quick reference.
- Install the bottom hanging hooks on lower shelf into the bottom notched slots in uprights, as shown at lower right (**DETAIL 21B**).
- Install the top hanging hooks on upper shelf into the top notched slots in uprights, as shown at upper right (**DETAIL 21C**).
- Remember to engage rotating locks on each shelf before proceeding to next shelf.
- An optional shelf can be installed between upper and lower shelves if required (**DETAIL 21D**).

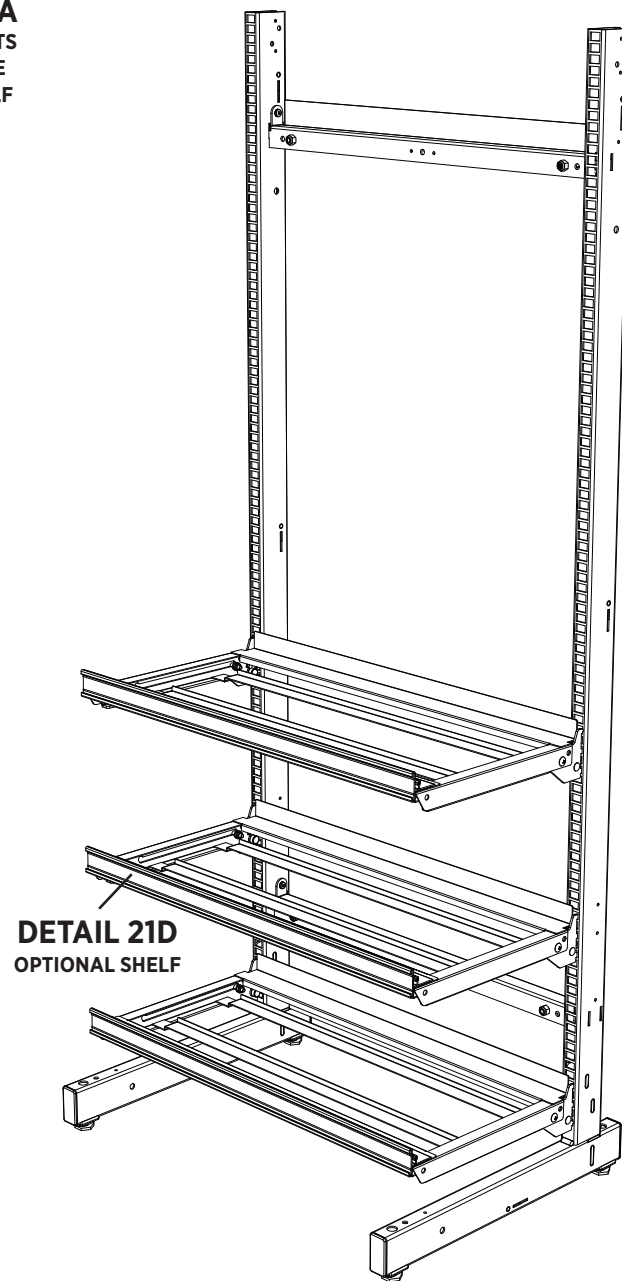
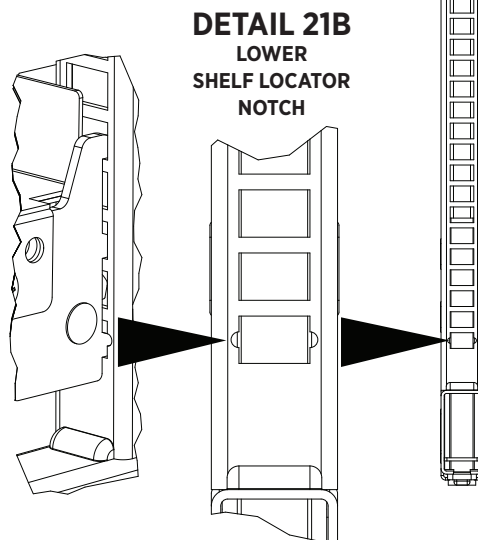
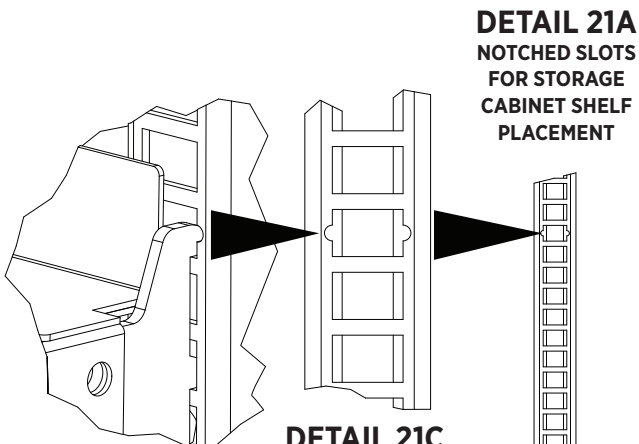

THE MANUFACTURER OF THIS MERCHANDISING SYSTEM ASSUMES NO LIABILITY FOR INJURY, DAMAGE OR LOSS OF PROPERTY AS A RESULT OF IMPROPER ASSEMBLY, INSTALLATION, AND/OR USE OF THIS DISPLAY.

Storage Cabinet Installation - 5.3

STEP 22: Install Shelf Liners On All Storage Cabinet Shelves

- Remove backing from adhesive strips on underside of Shelf Liner, and align it over sliding tray on shelf.
- Press Shelf Liner into place on shelf tray so adhesive strips make contact and adhere to metal flanges.

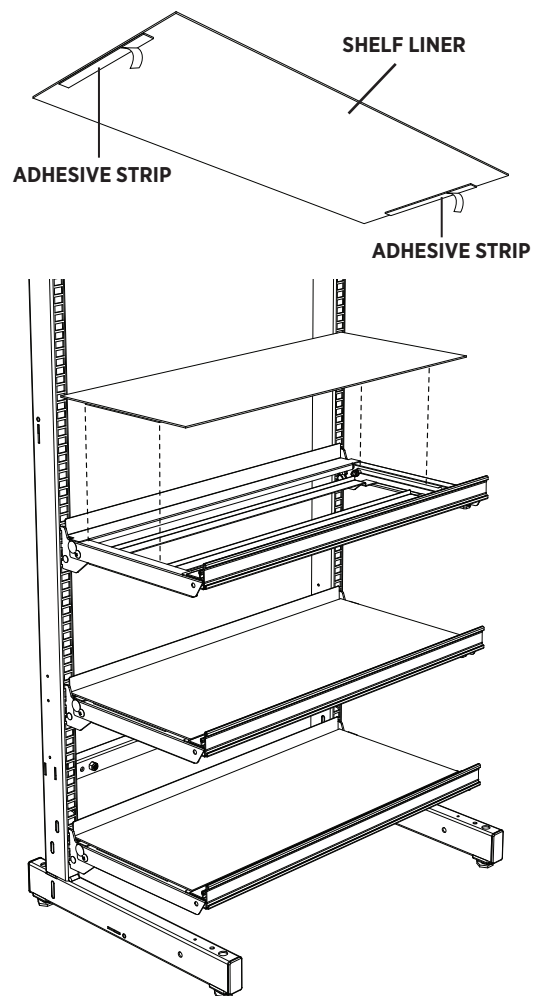

THE MANUFACTURER OF THIS MERCHANDISING SYSTEM ASSUMES NO LIABILITY FOR INJURY, DAMAGE OR LOSS OF PROPERTY AS A RESULT OF IMPROPER ASSEMBLY, INSTALLATION, AND/OR USE OF THIS DISPLAY.

STEP 23: Install Sliding Tracks For Cabinet Storage Doors

- Slide Upper Cabinet Door Sliding Track into channel strip of upper shelf, as shown (DETAIL 23A).
- Slide Lower Cabinet Door Sliding Track into channel strip of bottom shelf, as shown (DETAIL 23B).

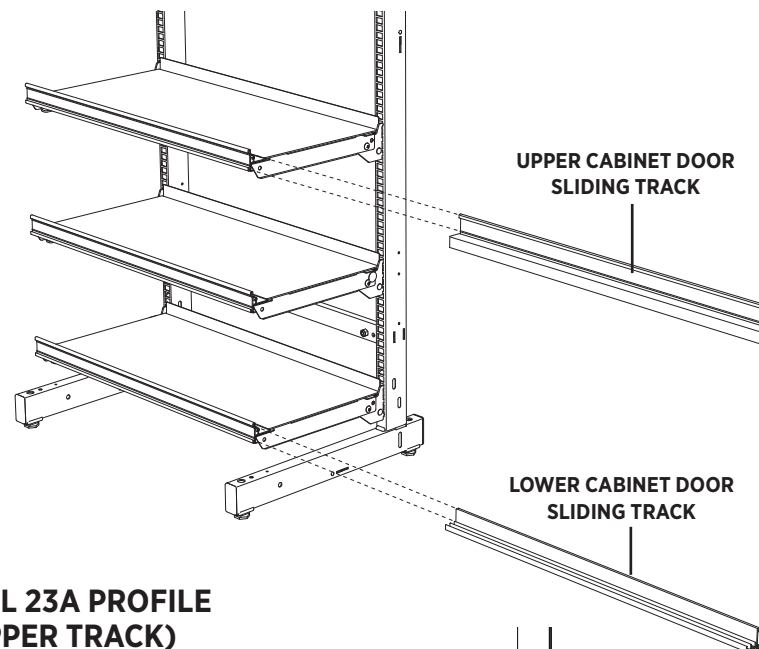

DETAIL 23A PROFILE
(UPPER TRACK)

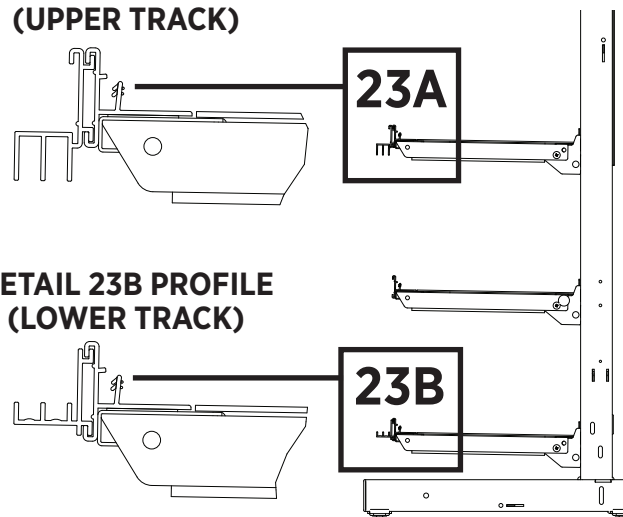

DETAIL 23B PROFILE
(LOWER TRACK)

STEP 24: Storage Cabinet Installation and Locking Sliding Tray Mechanisms - Planning Guide

- Refer to diagram below for the correct order of locking the sliding tray mechanisms on shelves (using plastic tree clips) during Storage Cabinet installation (**DETAIL 24A**).
- Locations indicated by circles, in diagram below, indicate where plastic tree clips can be installed to lock shelves prior to attachment of Storage Cabinet side panels.
- Work from left to right on fixture assembly, installing shelves for one Storage Cabinet at a time before proceeding to the next (**DETAIL 24B**).
- If an optional shelf is required between the upper and lower shelves, lock the sliding tray mechanism on both sides of shelf prior to attaching shelf to uprights.
- Install left and right side panels of first Storage Cabinet, then proceed to of adjacent cabinets, as shown below. **NOTE: Only one side panel is used between adjacent cabinets.**

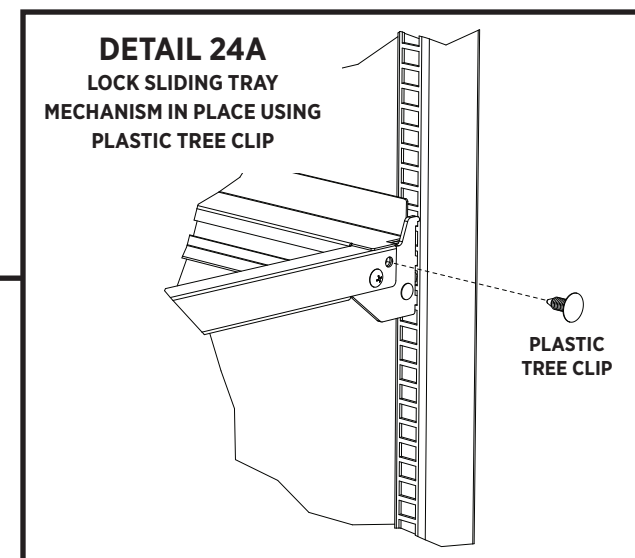

INSTALLATION OF A SINGLE STORAGE CABINET

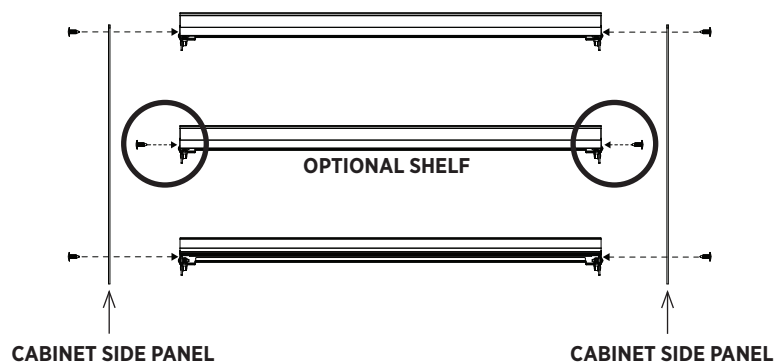

DETAIL 24B
DIAGRAM SHOWING
INSTALLATION OF A SINGLE
STORAGE CABINET

INSTALLATION OF TWO OR MORE ADJACENT STORAGE CABINETS

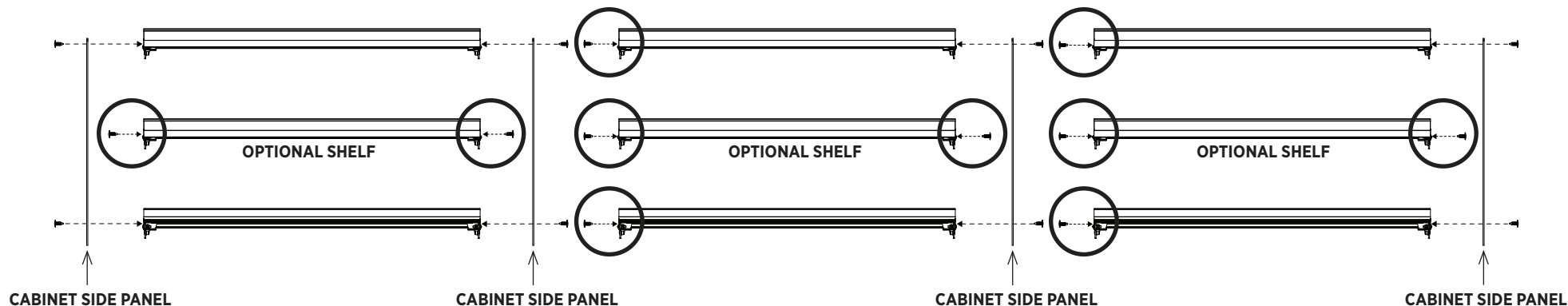

Storage Cabinet Installation - 5.5

STEP 25: Install Storage Cabinet Side Panels

- Align holes in each Cabinet Side Panel with holes on sides of top and bottom shelves and install four (4) plastic tree clips to secure, as shown below.
- Adjacent Storage Cabinets share a single Cabinet Side Panel.
- Refer to Step 24, page 22, as needed for instructions when installing adjacent Storage Cabinets.

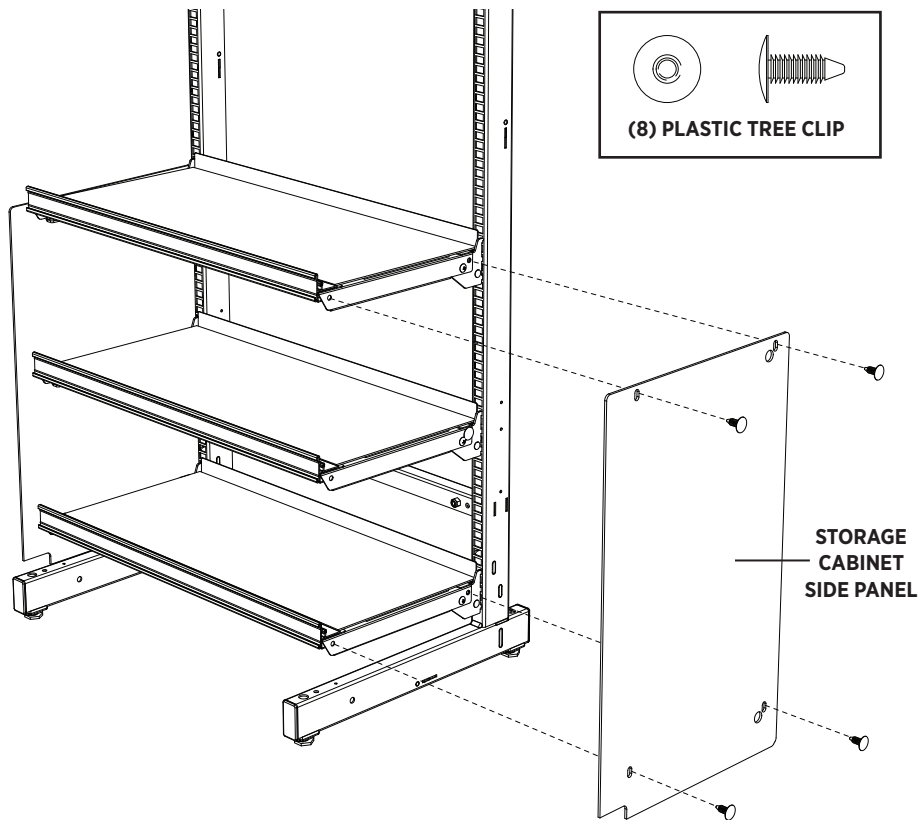

THE MANUFACTURER OF THIS MERCHANDISING SYSTEM ASSUMES NO LIABILITY FOR INJURY, DAMAGE OR LOSS OF PROPERTY AS A RESULT OF IMPROPER ASSEMBLY, INSTALLATION, AND/OR USE OF THIS DISPLAY.

STEP 26: Install Storage Cabinet Sliding Doors

- Lift and drop left-side door into rear channel of upper and lower sliding tracks. Lift and drop right-side door into front channel of upper and lower sliding tracks (**DETAIL 26**).
- Repeat STEPS 20-26 until all Storage Cabinets are installed.

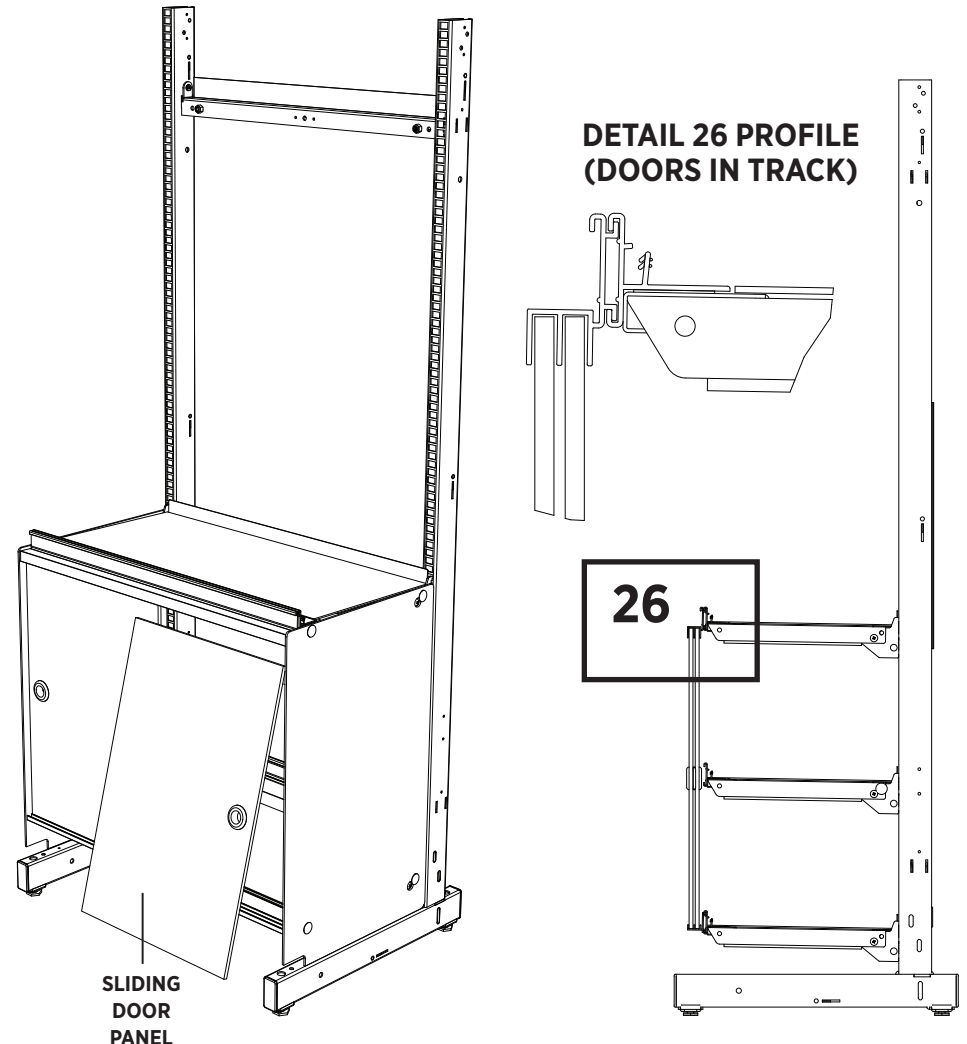

Shelf Installation - 6.1

STEP 27: General Shelf Installation

When Storage Cabinets are not present:

- Start shelf installation at the left end of the set.
- Install first shelf into bottom slots of Low Profile Base Structure Uprights.
- Lock shelf in place by rotating locks into slotted uprights **(DETAIL 27A)**.
- When 6-inch shelf spacing is required, use supplied magnetic shelf positioning brackets to assist with accurate spacing of shelves at 6-inch centers in slotted uprights **(DETAIL 27B)**.
- Install remaining shelves in same manner, per planogram, locking each shelf before proceeding to the next.

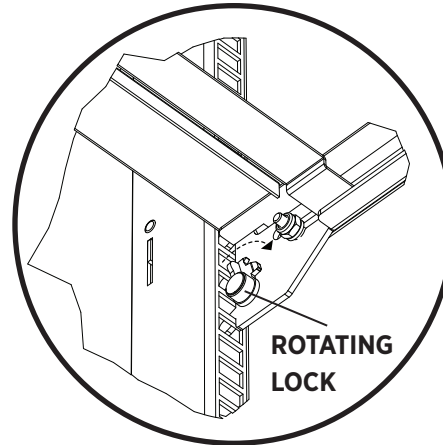

DETAIL 27A

When Storage Cabinets are present:

- Start shelf installation at the left end of the set.
- When 6-inch shelf spacing is required, use supplied magnetic shelf positioning brackets to assist with accurate spacing of shelves at 6-inch centers above top shelf of Storage Cabinet assembly **(DETAIL 27B)**.
- Install remaining shelves in same manner.

DETAIL 27B

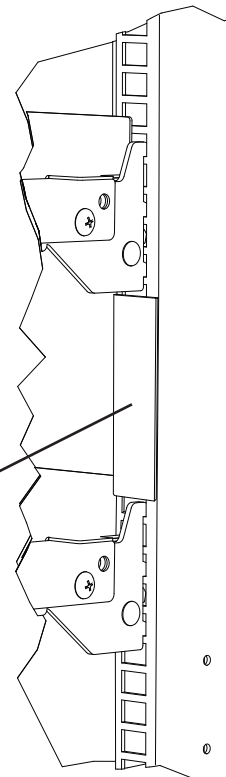

MAGNETIC SHELF
POSITIONING BRACKET
SHOWN ATTACHED TO
SLOTTED UPRIGHT

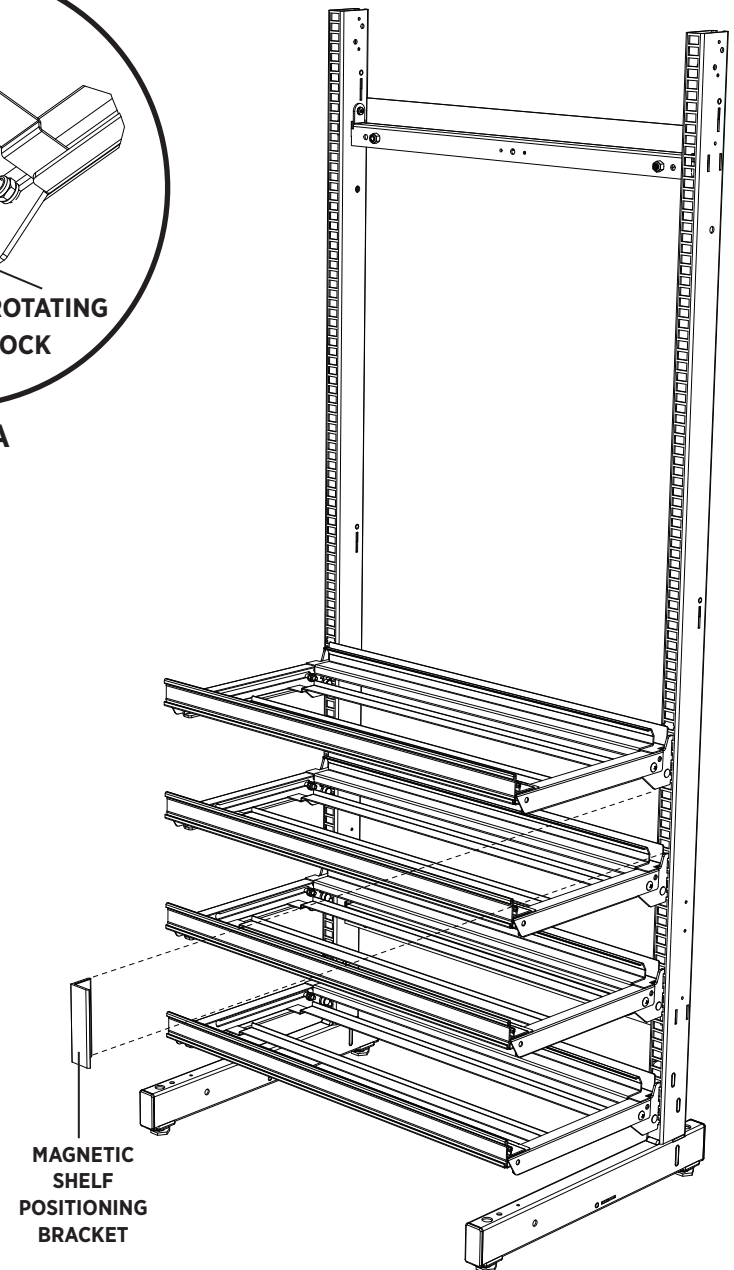

MAGNETIC
SHELF
POSITIONING
BRACKET

THE MANUFACTURER OF THIS MERCHANDISING SYSTEM ASSUMES NO LIABILITY FOR INJURY, DAMAGE OR LOSS OF PROPERTY AS A RESULT OF IMPROPER ASSEMBLY, INSTALLATION, AND/OR USE OF THIS DISPLAY.

Optional Shelf Installation - 6.2

STEP 28 (OPTIONAL ADD-ON): Install Storage Shelf Behind Top Sign

If desired, an additional shelf can be installed behind the Top Sign to create a concealed storage area. Refer to installation planogram.

- Pivot Top Sign frame upward to open position (**DETAIL 28**). Align and install shelf so it will be flush with the bottom edge of Top Sign frame when the frame is in closed position.
- Lock shelf in place in slotted uprights by rotating both locks into slots in slotted uprights.
- Repeat as required.

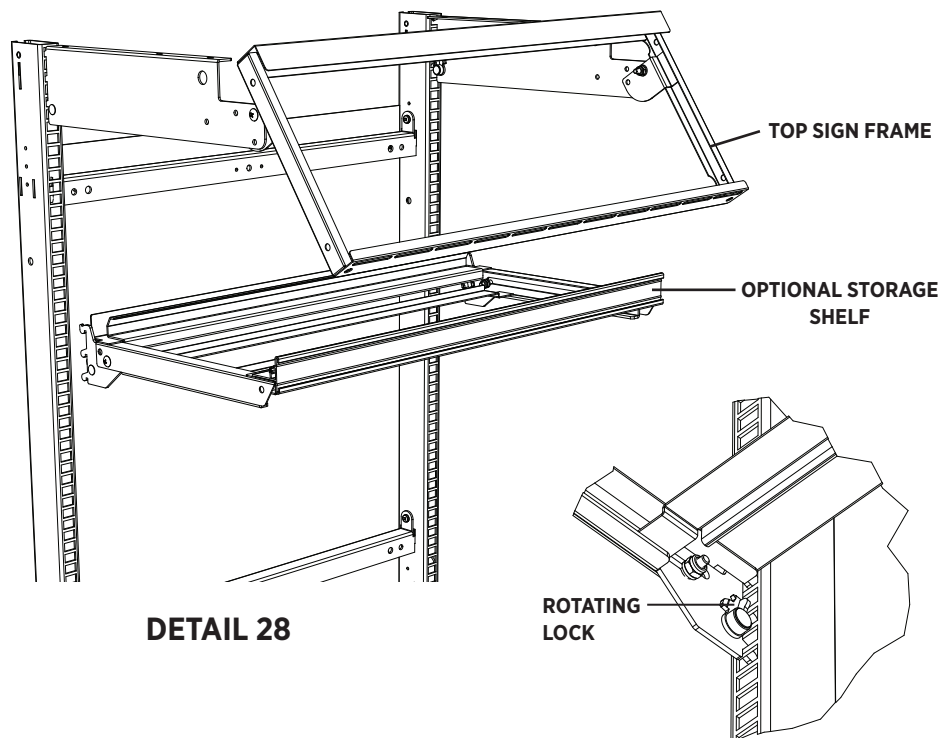

THE MANUFACTURER OF THIS MERCHANDISING SYSTEM ASSUMES NO LIABILITY FOR INJURY, DAMAGE OR LOSS OF PROPERTY AS A RESULT OF IMPROPER ASSEMBLY, INSTALLATION, AND/OR USE OF THIS DISPLAY.

STEP 29 (OPTIONAL ADD-ON): Install Shelf Liner On Storage Shelf

- Refer to installation planogram to determine if a Shelf Liner is required on the optional Storage Shelf installed in Step 28. If so, the Rear Shelf Extrusion must be removed from the shelf.
- Remove Rear Shelf Extrusion by flexing it toward the front of the shelf to disengage it from metal flange under shelf. Discard after removal.
- Refer to Step 22, page 21, for Shelf Liner installation instructions.

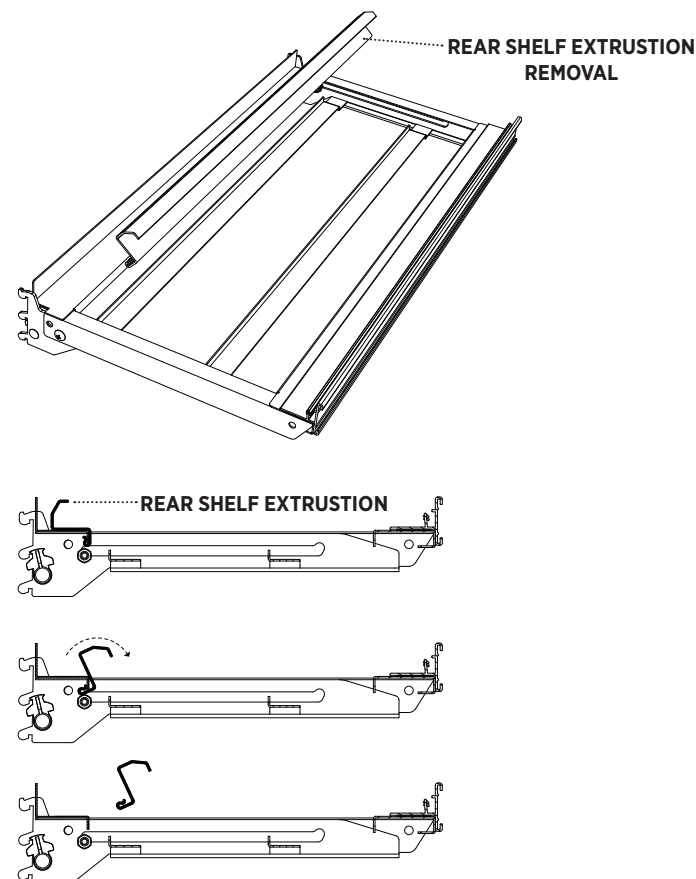

Install Pushers - 7.1

STEP 30: Identify Spring Load Pusher Types

Identify spring load pusher styles and refer to your specific planogram for pusher layouts on shelves.

- Review pusher installation and additional features, Steps 31-34.
- Proceed to pusher installation guide, steps 35-38.

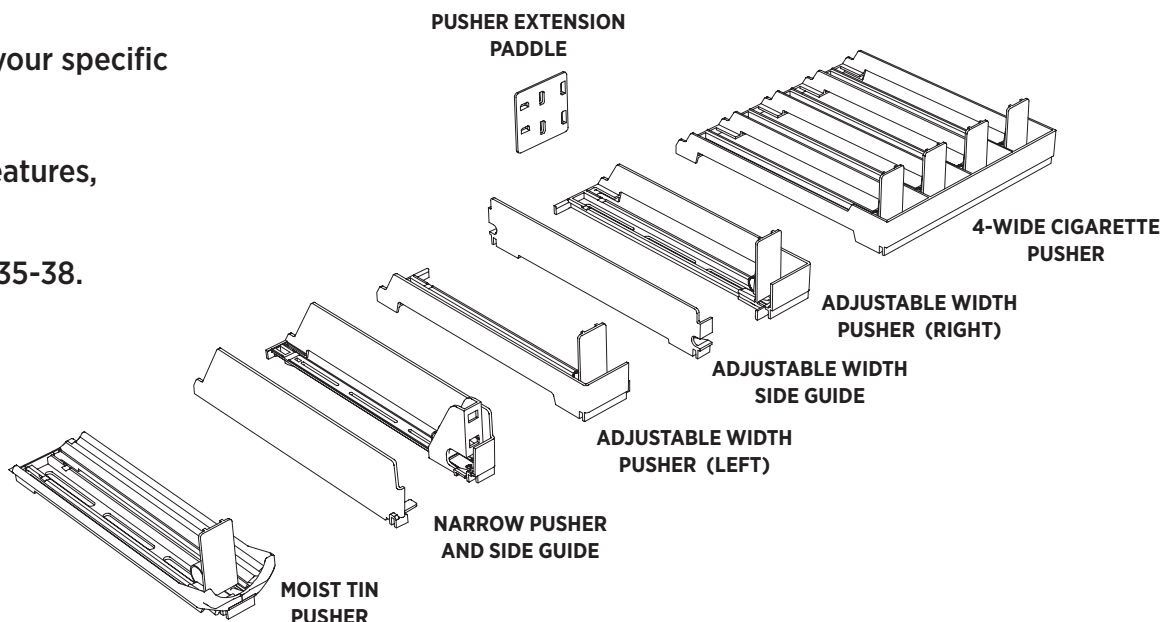

STEP 31: Attaching Pushers To Shelf

Attach all pushers and side guides to shelves by inserting the back end of each part under the rear shelf extrusion, and aligning the channel at the front end of each part over the protruding leg of the retainer strip.

Press each pusher or side guide firmly into place before proceeding.

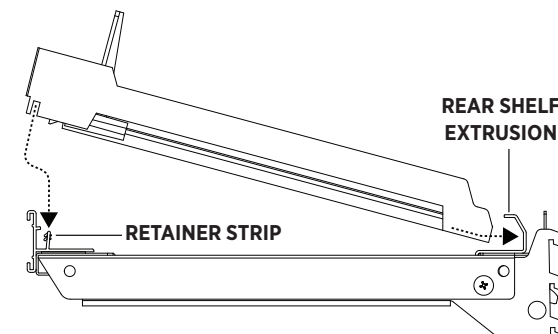
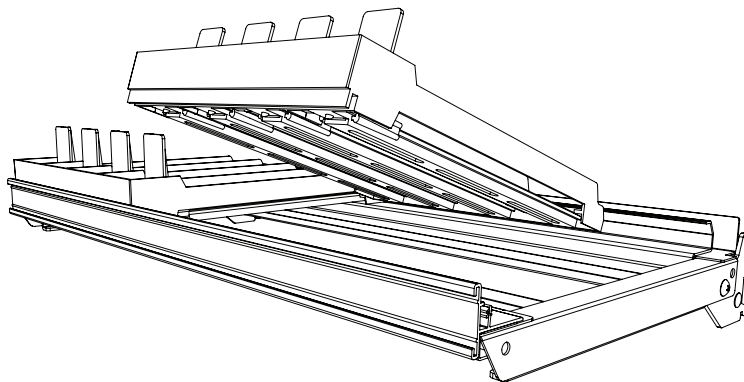

THE MANUFACTURER OF THIS MERCHANDISING SYSTEM ASSUMES NO LIABILITY FOR INJURY, DAMAGE OR LOSS OF PROPERTY AS A RESULT OF IMPROPER ASSEMBLY, INSTALLATION, AND/OR USE OF THIS DISPLAY.

Install Pushers - 7.2

STEP 32: Snap-Off Spacing Tabs On Left And Right Adjustable Width Pushers

Adjustable Width Pushers have snap-off spacing tabs which allow tighter spacing between adjacent pushers to accommodate narrow product packaging.

Both front and back spacing tabs must be removed from the pusher cartridge (**DETAIL 32**).

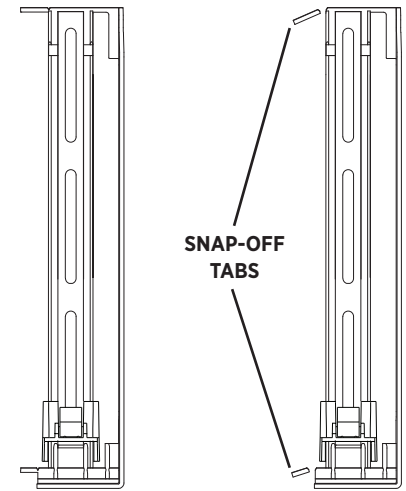
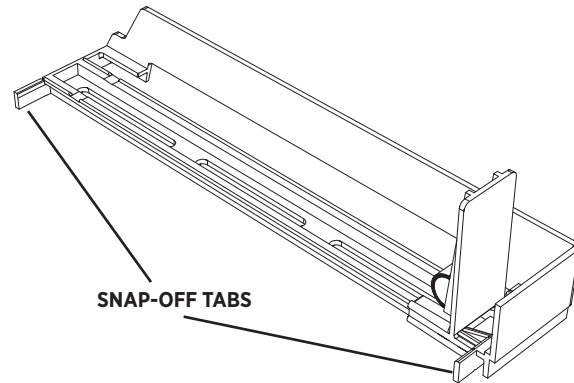

DETAIL 32 - TOP VIEW

STEP 33: Locking Pusher Paddle Feature

All pusher types feature a smooth-gliding locking pusher paddle for easy package loading. Push paddle all the way to the back of the cartridge until it locks into place. Gently push top of paddle back and slightly upward to release.

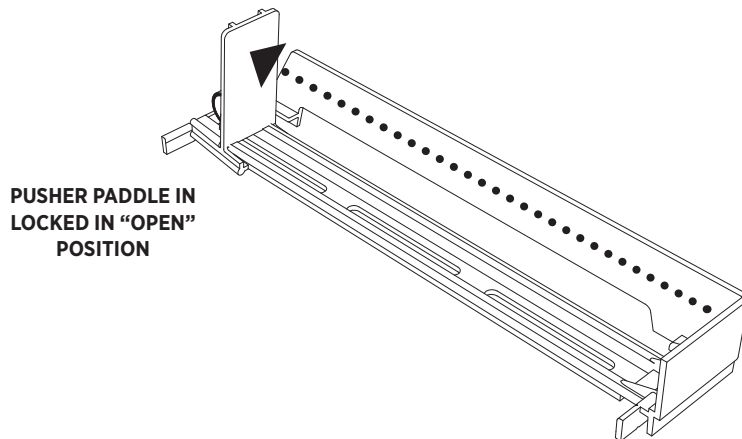

THE MANUFACTURER OF THIS MERCHANDISING SYSTEM ASSUMES NO LIABILITY FOR INJURY, DAMAGE OR LOSS OF PROPERTY AS A RESULT OF IMPROPER ASSEMBLY, INSTALLATION, AND/OR USE OF THIS DISPLAY.

STEP 34: Pusher Extension Paddles (Optional - OTP Applications)

Attach Pusher Extension Paddles over standard pusher paddles of Adjustable Width and Narrow Pushers to assist with pushing wide packages.

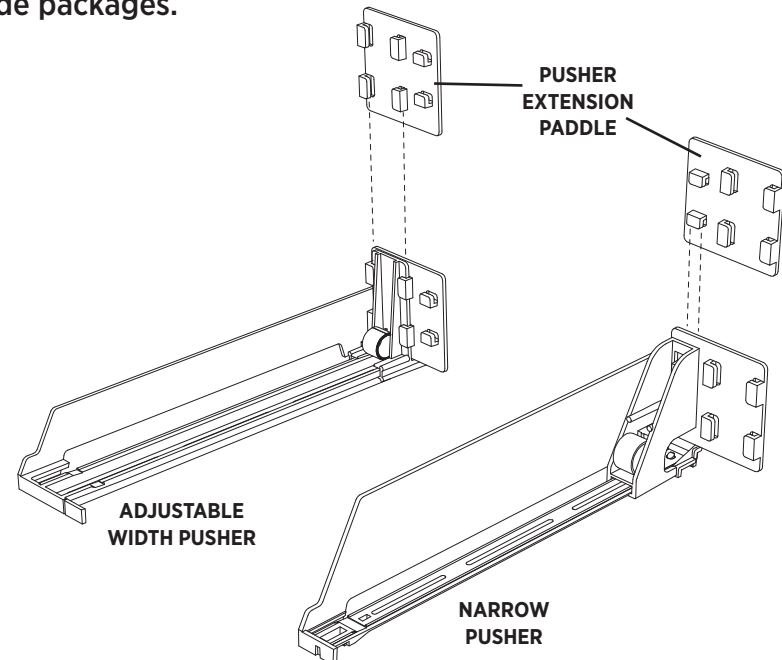

Install Pushers - 7.3

STEP 35: Pusher Installation Guide For Cigarette Pack Applications:

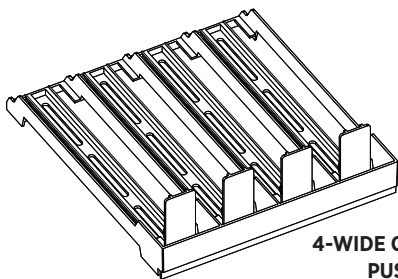

4-WIDE CIGARETTE PUSHER

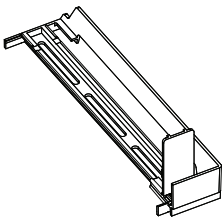

ADJUSTABLE WIDTH PUSHER (RIGHT)

4-WIDE PUSHER (2), ADJUSTABLE WIDTH PUSHER (1) - TOTAL PACK FACINGS (9)

STEP 1:
INSTALL ALL
4-WIDE PUSHERS FIRST,
FROM LEFT TO RIGHT



STEP 2:
INSTALL ADJUSTABLE WIDTH
PUSHER(S) TO THE RIGHT
OF 4-WIDE PUSHERS

4-WIDE PUSHER (3), ADJUSTABLE WIDTH PUSHER (2) - TOTAL PACK FACINGS (14)



AIM 3 FT SHELF

4-WIDE PUSHER (4), ADJUSTABLE WIDTH PUSHER (3) - TOTAL PACK FACINGS (19)



AIM 4 FT SHELF

STEP 36: Pusher Installation Guide For OTP Package Applications:

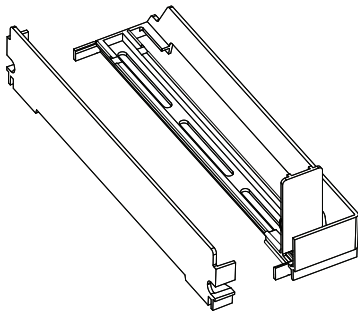

ADJUSTABLE WIDTH PUSHER (RIGHT)
AND SIDE GUIDE

STEP 1:
INSTALL SIDE GUIDE AT
LEFT END OF SHELF

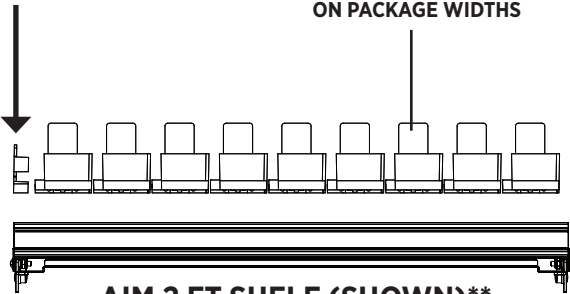

AIM 2 FT SHELF (SHOWN)**

** LOADING INSTRUCTIONS FOR ADJUSTABLE WIDTH
PUSHERS APPLY TO 2 FT, 3 FT AND 4 FT SHELF WIDTHS

WHEN TIGHTER SPACING IS REQUIRED,
BREAK-OFF TABS CAN BE REMOVED. SEE STEP 32.

Install Pushers - 7.4

STEP 37: Pusher Installation Guide For Moist Tin Applications:

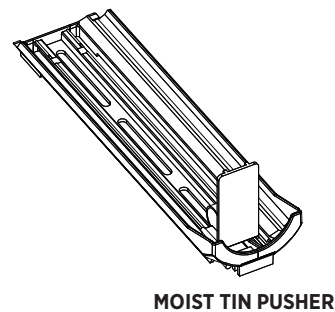

MOIST TIN PUSHERS (8) – TOTAL TIN FACINGS (8)

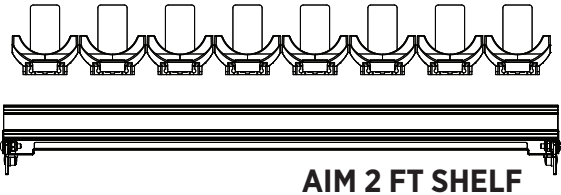

MOIST TIN PUSHERS (12) – TOTAL TIN FACINGS (12)

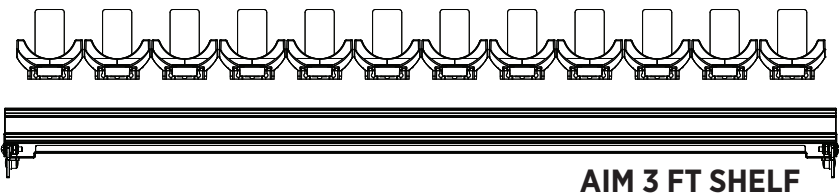

MOIST TIN PUSHERS (16) – TOTAL TIN FACINGS (16)

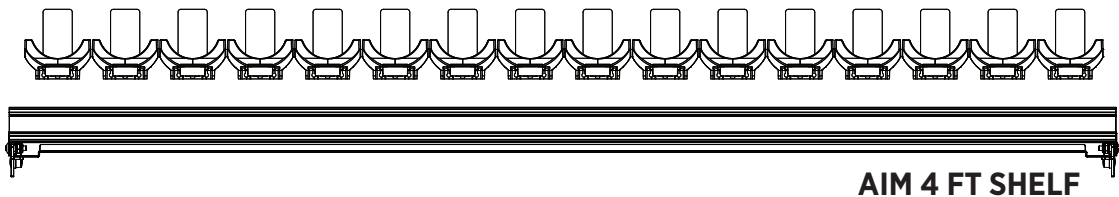

STEP 38: Pusher Installation Guide For Narrow Packaging Applications:

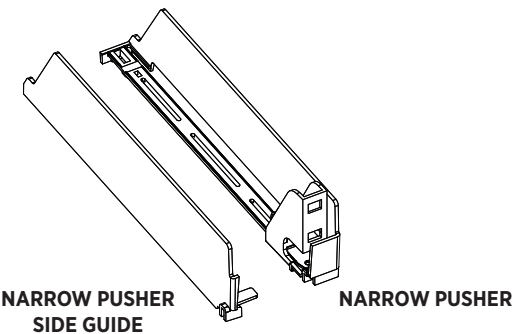

STEP 1:
INSTALL NARROW
SIDE GUIDE AT LEFT
END OF TRAY



STEP 2:
INSTALL NARROW PUSHERS
AS REQUIRED BASED ON
PACKAGE WIDTHS

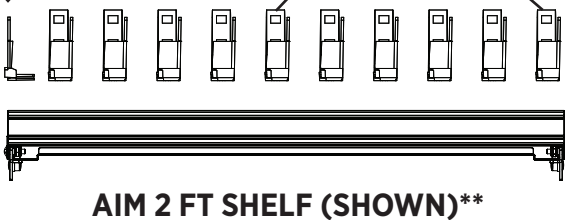

** LOADING INSTRUCTIONS FOR NARROW PUSHERS
APPLY TO 2FT, 3FT AND 4FT SHELF WIDTHS